

**IDK-LOK**<sup>®</sup>  
Ball Valves

**High  
Performance  
Valves**

REDUCE BORE VERSION

ATTENTION:  
TOOL FOR BALL-SEATS ASSEMBLY & DISASSEMBLY  
INCLUDED IN SCOPE OF SUPPLY

CHARACTERISTICS AND FEATURES :

1. FLANGE TYPE - REFER ATTACHMENT "A"

2. DIMENSION TYPE - REFER ATTACHMENT "B"

3. BALL SEALS DETAILS - REFER ATTACHMENT "C"

4. BALL SEALS DETAILS - REFER ATTACHMENT "D"

**Dimensional  
Tables**

ØBB1

# Index

Page

Type

3 / 7

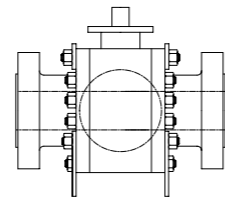

8 / 11

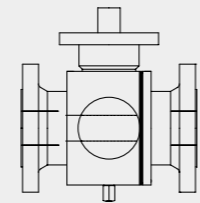

12 / 17

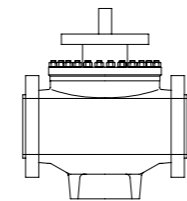

18 - 20 - 21  
22 - 23 - 24

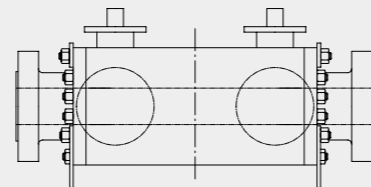

19 - 25 - 26  
27 - 28 - 29

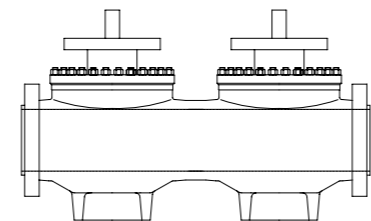

30 / 31

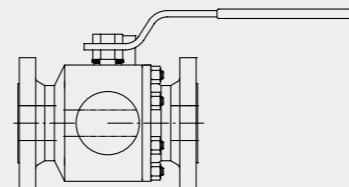

32 / 33

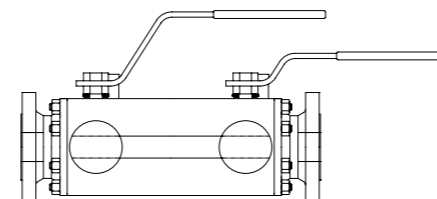

**IDK-LOK**

Trunnion Side Entry Ball Valve **VBST**

## Side Entry

### Main Features

- Bolted Body - All Forged Construction.
- Soft / Metal Seated.
- Self Relieving or Double Piston Effect.
- Anti Blow-Out Stem.
- Double Block & Bleed.
- Fire Safe API 6FA - API 607 ISO 14097.
- Antistatic Device.
- Emergency Sealant Injection to Stem & Seats.
- Materials in Accordance to NACE MR 01.75
- Above / Under Ground Installation.

### Valve Parts

Pos.	Description
01	Body
02	Seat / Insert
03	Ball
04	Stem
05	Stem cover
06	Flange
07	Trunnion
08	Ball Support
09	Operator Flange
13	Lifting Lugs
14	Valve Support
51	Stud
52	Nut
54	Screw
55	Thrust Washer
56	Thrust Bearing
58	Plug
59	Bleeder
62	Seal
63	Gasket
66	Spring
69	Pin
70	Key

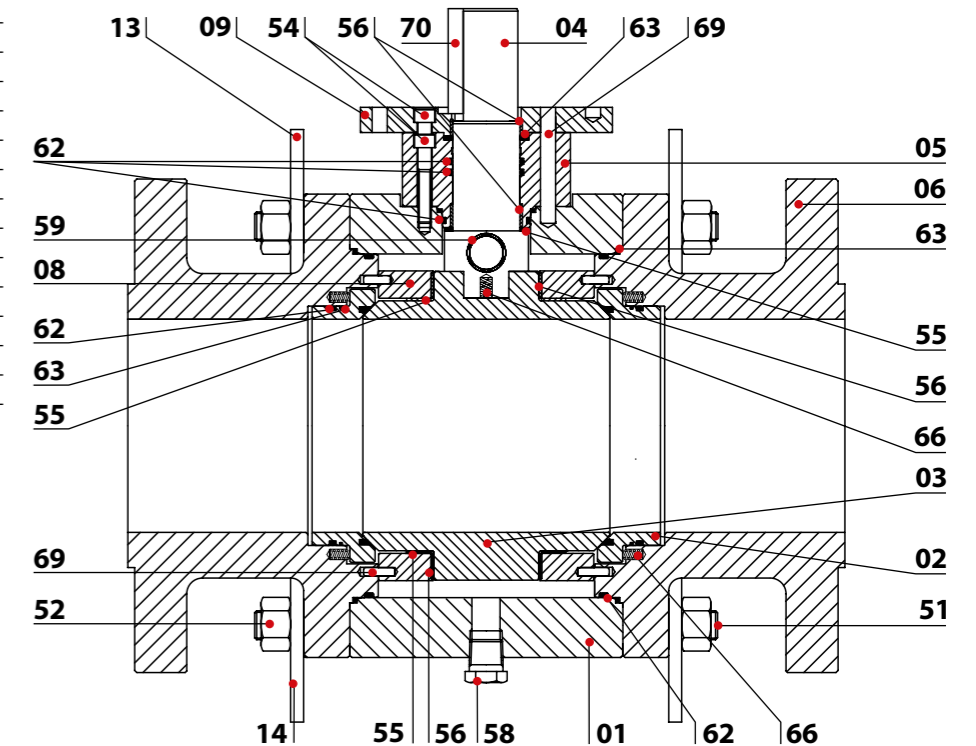
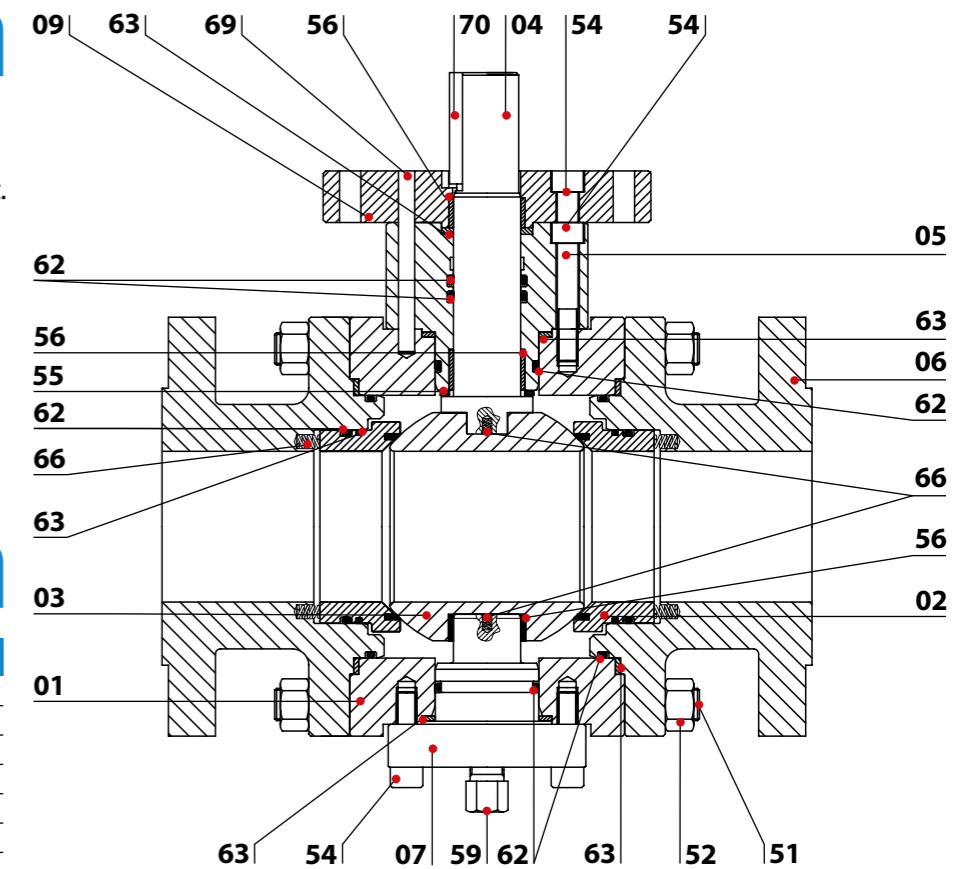

# ASME 150 - 300 - 600 - 900 - 1500 Lbs

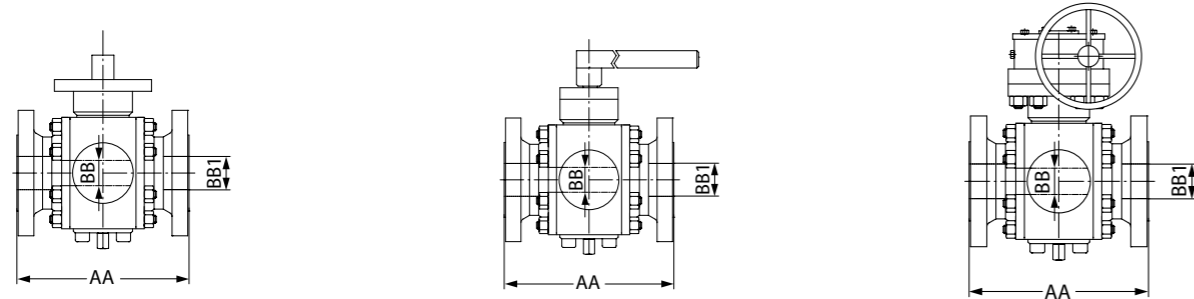

Full Bore DN	AA			BB	BB1	Valve Approx. Weight (Kg)	Reduce Bore DN	AA			BB	BB1	Valve Approx. Weight (Kg)
	RF	RTJ	BW					RF	RTJ	BW			
<b>Class 150</b>													
1 1/2"	165	178	190	38	38	22	2"x 1 1/2"	178	190	216	38	49	26
2"	178	190	216	49	49	28	3"x 2"	203	216	283	49	74	31
3"	203	216	283	74	74	55	4"x 3"	229	241	305	74	100	63
4"	229	241	305	100	100	90	6"x 4"	394	406	457	100	150	102
<b>Class 300</b>													
1 1/2"	190	203	190	38	38	25	2"x 1 1/2"	216	232	216	38	49	29
2"	216	232	216	49	49	29	3"x 2"	283	298	283	49	74	34
3"	283	298	283	74	74	57	4"x 3"	305	321	305	74	100	65
4"	305	321	305	100	100	110	6"x 4"	403	419	457	100	150	133
<b>Class 600</b>													
1 1/2"	241	241	241	38	38	28	2"x 1 1/2"	292	295	292	38	49	33
2"	292	295	292	49	49	35	3"x 2"	356	359	356	49	74	40
3"	356	359	356	74	74	80	4"x 3"	432	435	432	74	100	102
4"	432	435	432	100	100	133	6"x 4"	559	562	559	100	150	165
<b>Class 900</b>													
1 1/2"	305	305	305	38	38	40	2"x 1 1/2"	368	371	368	38	49	52
2"	368	371	368	49	49	53	3"x 2"	381	384	381	49	74	72
3"	381	384	381	74	74	93	4"x 3"	457	460	457	74	100	120
4"	457	460	457	100	100	170	6"x 4"	610	613	610	100	150	232
<b>Class 1500</b>													
1 1/2"	305	305	305	38	38	40	2"x 1 1/2"	368	371	368	38	49	52
2"	368	371	368	49	49	53	3"x 2"	470	473	470	49	74	75
3"	470	473	470	74	74	118	4"x 3"	546	549	546	74	100	143
4"	546	549	546	100	100	225	6"x 4"	705	711	705	100	144	300
<b>Class 2500</b>													
1 1/2"	387	387	387	38	38	48	2"x 1 1/2"	451	454	451	38	42	65
2"	451	454	451	42	42	93	3"x 2"	578	584	578	42	62	165
3"	578	584	578	62	62	215	4"x 3"	673	683	673	62	87	280
4"	673	683	673	87	87	385	6"x 4"	914	927	914	87	131	540

# API 2000 - 3000 - 5000 - 10000 psi

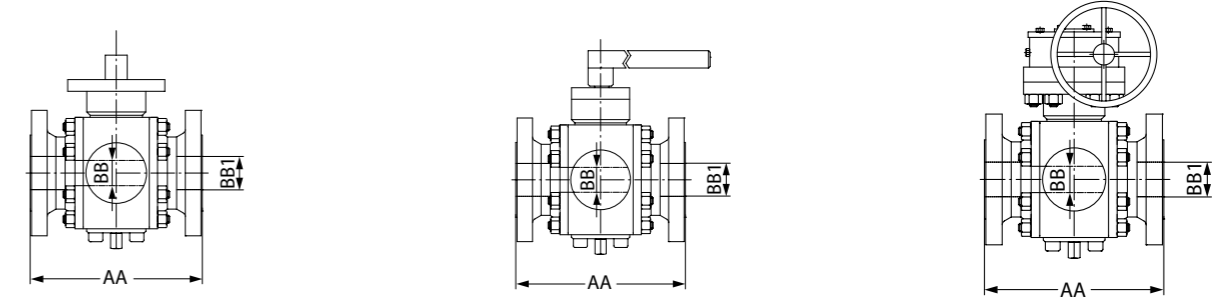

Full Bore DN	AA			Valve Approx. Weight (Kg)	Full Bore DN	AA			Valve Approx. Weight (Kg)
	RTJ					BB	BB1	BB	
<b>Class 2000</b>									
1 13/16"	241 (*)			28	2 1/16" x 1 13/16"	295	46	52.4	30
2 1/16"	295			35	2 9/16" x 2 1/16"	333	46	52.4	45
2 9/16"	333			55	3 1/8" x 2 9/16"	359	46	52.4	70
3 1/8"	359			80	4 1/16" x 3 1/8"	435	46	52.4	102
<b>Class 3000</b>									
1 13/16"	305 (*)			40	2 1/16" x 1 13/16"	371	46	52.4	45
2 1/16"	371			55	2 9/16" x 2 1/16"	422	46	52.4	60
2 9/16"	422			70	3 1/8" x 2 9/16"	384	46	52.4	90
3 1/8"	384			95	4 1/16" x 3 1/8"	460	46	52.4	120
<b>Class 5000</b>									
1 13/16"	371 (*)			40	2 1/16" x 1 13/16"	371	46	52.4	45
2 1/16"	371			55	2 9/16" x 2 1/16"	473	46	52.4	79
2 9/16"	473			85	3 1/8" x 2 9/16"	473	46	52.4	118
3 1/8"	473			130	4 1/16" x 3 1/8"	549	46	52.4	160
<b>Class 10000</b>									
1 13/16"	464			60	2 1/16" x 1 13/16"	521	46	52.4	75
2 1/16"	521			170	2 9/16" x 2 1/16"	565	46	52.4	185
2 9/16"	565			205	3 1/8" x 2 9/16"	619	46	52.4	240
3 1/16"	619			330	4 1/16" x 3 1/16"	670	46	52.4	370

\*(Manufacturer Standard)

# ASME 150 - 300 - 600 Lbs

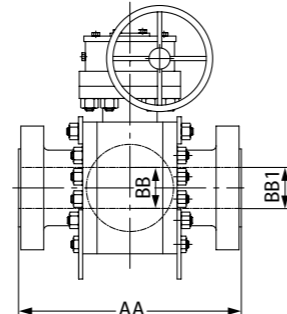
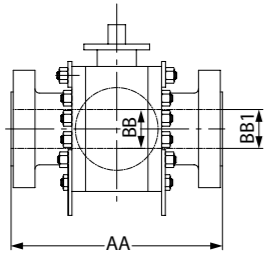

Full Bore DN	AA			BB	BB1	Valve Approx. Weight (Kg)
	RF	RTJ	BW			
<b>Class 150</b>						
6"	394	406	457	150	150	185
8"	457	470	521	201	201	270
10"	533	546	559	252	252	385
12"	610	622	635	303	303	562
14"	686	698	762	334	334	765
16"	762	775	838	385	385	1030
18"	864	876	914	436	436	1218
20"	914	927	991	487	487	1800
24"	1067	1079	1143	589	589	3097
26"	1143	N/A	1245	633	633	3770
28"	1245	N/A	1346	684	684	4635
30"	1295	N/A	1397	735	735	5370
32"	1372	N/A	1524	779	779	6960
34"	1473	N/A	1626	830	830	7950
36"	1524	N/A	1727	874	874	8950
40"	1753	N/A	1956	976	976	12700

Full Bore DN	AA			BB	BB1	Valve Approx. Weight (Kg)
	RF	RTJ	BW			
<b>Class 300</b>						
6"	403	419	457	150	150	205
8"	502	517	521	201	201	310
10"	568	584	559	252	252	507
12"	648	664	635	303	303	740
14"	762	778	762	334	334	1038
16"	838	854	838	385	385	1428
18"	914	930	914	436	436	1602
20"	991	1010	991	487	487	2207
24"	1143	1165	1143	589	589	3470
26"	1245	1270	1245	633	633	4810
28"	1346	1372	1346	684	684	5920
30"	1397	1422	1397	735	735	6740
32"	1524	1553	1524	779	779	8050
34"	1626	1654	1626	830	830	9260
36"	1727	1756	1727	874	874	10200
40"	1956	1956	1956	976	976	13950

Full Bore DN	AA			BB	BB1	Valve Approx. Weight (Kg)
	RF	RTJ	BW			
<b>Class 600</b>						
6"	559	562	559	150	150	255
8"	660	664	660	201	201	487
10"	787	791	787	252	252	760
12"	838	841	838	303	303	1070
14"	889	892	889	334	334	1085
16"	991	994	991	385	385	1527
18"	1092	1095	1092	436	436	2097
20"	1194	1200	1194	487	487	2640
24"	1397	1406	1397	589	589	4920
26"	1448	1460	1448	633	633	5820
28"	1549	1562	1549	684	684	6760
30"	1651	1664	1651	735	735	8490
32"	1778	1794	1778	779	779	9930
34"	1930	1946	1930	830	830	11450
36"	2083	2098	2083	874	874	13450
40"	2337	2337	2337	976	976	18490

Reduce Bore DN	AA					Valve Approx. Weight (Kg)
	RF	RTJ	BW	BB	BB1	
<b>Class 150</b>						
8"x 6"	457	470	521	150	201	188
10"x 8"	533	546	559	201	252	290
12"x 10"	610	622	635	252	303	465
14"x 12"	686	698	762	303	334	562
16"x 14"	762	775	838	334	385	830
18"x 16"	864	876	914	385	436	1080
20"x 18"	914	927	991	436	487	1170
24"x 20"	1067	1079	1143	487	589	1298
30"x 24"	1295	N/A	1397	589	735	1820
36"x 30"	1524	N/A	1728	735	874	2048

Reduce Bore DN	AA					Valve Approx. Weight (Kg)
	RF	RTJ	BW	BB	BB1	
<b>Class 300</b>						
8"x 6"	502	517	521	150	201	222
10"x 8"	568	584	559	201	252	297
12"x 10"	648	664	635	252	303	597
14"x 12"	762	778	762	303	334	820
16"x 14"	838	854	838	334	385	1130
18"x 16"	914	930	914	385	436	1598
20"x 18"	991	1010	991	436	487	1797
24"x 20"	1143	1165	1143	487	589	2740
30"x 24"	1397	1422	1397	589	735	4630
36"x 30"	1727	1756	1727	735	874	8300

Reduce Bore DN	AA					Valve Approx. Weight (Kg)
	RF	RTJ	BW	BB	BB1	
<b>Class 600</b>						
8"x 6"	660	664	660	150	201	290
10"x 8"	787	791	787	201	252	547
12"x 10"	838	841	838	252	303	810
14"x 12"	889	892	889	303	334	1140
16"x 14"	991	994	991	334	385	1360
18"x 16"	1092	1095	1092	385	436	1682
20"x 18"	1194	1200	1194	436	487	2377
24"x 20"	1397	1406	1397	487	589	3250
30"x 24"	1651	1664	1651	589	735	5910
36"x 30"	2083	2098	2083	735	874	10540

# ASME 900 - 1500 - 2500 Lbs

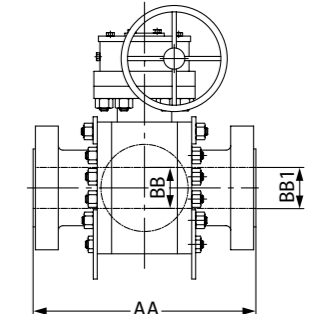
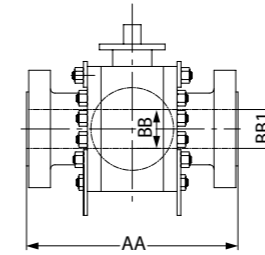

Full Bore DN	AA					Valve Approx. Weight (Kg)
	RF	RTJ	BW	BB	BB1	
<b>Class 900</b>						
6"	610	613	610	150	150	367
8"	737	740	737	201	201	600
10"	838	841	838	252	252	1027
12"	965	968	965	303	303	1558
14"	1029	1038	1029	322	322	1477
16"	1130	1140	1130	373	373	2157
18"	1219	1232	1219	423	423	2860
20"	1321	1333	1321	471	471	4220
24"	1549	1568	1549	570	570	6850

Full Bore DN	AA					Valve Approx. Weight (Kg)
	RF	RTJ	BW	BB	BB1	
<b>Class 1500</b>						
6"	705	711	705	144	144	485
8"	832	841	832	192	192	827
10"	991	1000	991	239	239	1507
12"	1130	1146	1130	287	287	2272
14"	1257	1276	1257	315	315	2880
16"	1384	1406	1384	360	360	4120
18"	1537	1559	1537	406	406	6260
20"	1664	1686	1664	454	454	9120
24"	2043	2071	2043	546	546	14320

Full Bore DN	AA					Valve Approx. Weight (Kg)
	RF	RTJ	BW	BB	BB1	
<b>Class 2500</b>						
6"	914	927	914	131	131	830
8"	1022	1038	1022	179	179	1435
10"	1270	1292	1270	223	223	2220
12"	1422	1445	1422	265	265	3350

Reduce Bore DN	AA					Valve Approx. Weight (Kg)
	RF	RTJ	BW	BB	BB1	
<b>Class 900</b>						
8"x 6"	737	740	737	150	201	447
10"x 8"	838	841	838	201	252	700
12"x 10"	965	968	965	252	303	1148
14"x 12"	1029	1038	1029	303	322	1643
16"x 14"	1130	1140	1130	322	373	1717
18"x 16"	1219	1232	1219	373	423	2437
20"x 18"	1321	1333	1321	423	471	3260
24"x 20"	1549	1568	1549	471	570	5430

Reduce Bore DN	AA					Valve Approx. Weight (Kg)
	RF	RTJ	BW	BB	BB1	
<b>Class 1500</b>						
8"x 6"	832	841	832	144	192	575
10"x 8"	991	1000	991	192	239	1032
12"x 10"	1130	1146	1130	239	287	1767
14"x 12"	1257	1276	1257	287	315	2537
16"x 14"	1384	1406	1384	315	360	3280
18"x 16"	1537	1559	1537	360	406	4980
20"x 18"	1664	1686	1664	406	454	7540
24"x 20"	2043	2071	2043	454	546	10950

Reduce Bore DN	AA					Valve Approx. Weight (Kg)
	RF	RTJ	BW	BB	BB1	
<b>Class 2500</b>						
8"x 6"	1022	1038	1022	131	179	1150
10"x 8"	1270	1292	1270	179	223	1750
12"x 10"	1422	1445	1422	223	265	2650

# API 2000 - 3000 - 5000 - 10000 Lbs

Full Bore DN	AA			Valve Approx. Weight (Kg)
	RTJ	BB	BB1	

<b>Class 2000</b>				
4" 1/16	435	103.2	103.2	140
5" 1/8	562	130.2	130.2	220
7" 1/16	740(*)	179.4	179.4	280

<b>Class 3000</b>				
4" 1/16	460	103.2	103.2	195
5" 1/8	613(*)	130.2	130.2	450
7" 1/16	613	179.4	179.4	770

<b>Class 5000</b>				
4" 1/16	549	103.2	103.2	205
5" 1/8	727(*)	130.2	130.2	560
7" 1/16	813(*)	179.4	179.4	850

<b>Class 10000</b>				
4" 1/16	670	103.2	103.2	430
5" 1/8	737	130.2	130.2	850
7" 1/16	889	179.4	179.4	1480

Full Bore DN	AA			Valve Approx. Weight (Kg)
	RTJ	BB	BB1	

<b>Class 2000</b>				
5" 1/8 x 4" 1/16	562	103.2	130.2	185
7" 1/16 x 5" 1/8	740(*)	130.2	179.4	240

<b>Class 3000</b>				
5" 1/8 x 4" 1/16	613(*)	103.2	130.2	260
7" 1/16 x 5" 1/8	613	130.2	179.4	480

<b>Class 5000</b>				
5" 1/8 x 4" 1/16	727(*)	103.2	130.2	300
7" 1/16 x 5" 1/8	813(*)	130.2	179.4	620

<b>Class 10000</b>				
5" 1/8 x 4" 1/16	737	103.2	130.2	510
7" 1/16 x 5" 1/8	889	130.2	179.4	1250

\*(Manufacturer Standard)



# Welded Body

## Main Features

- Welded Body - Cast or Forged body and closure.
- Soft / Metal Seated.
- Self Relieving or Double Piston Effect Seat.
- Anti Blow-Out stem.
- Double Block & Bleed.
- Fire Safe API 6FA - API 607 ISO 14097.
- Antistatic device.
- Emergency sealant injection to stem & seats.
- Materials in accordance to NACE MR 01.75.
- Above / under ground installation.

## Valve Parts

Pos.	Description
01	Body
02	Seat Insert
03	Ball
04	Stem
05	Stem cover
06	Flange
07	Trunion
08	Ball Support
09	Operator Flange
13	Lifting Lugs
14	Valve Support
54	Screw
55	Thrust Washer
56	Thrust Bearing
58	Plug
59	Bleeder
62	Seal
63	Gasket
66	Spring
69	Pin
70	Key

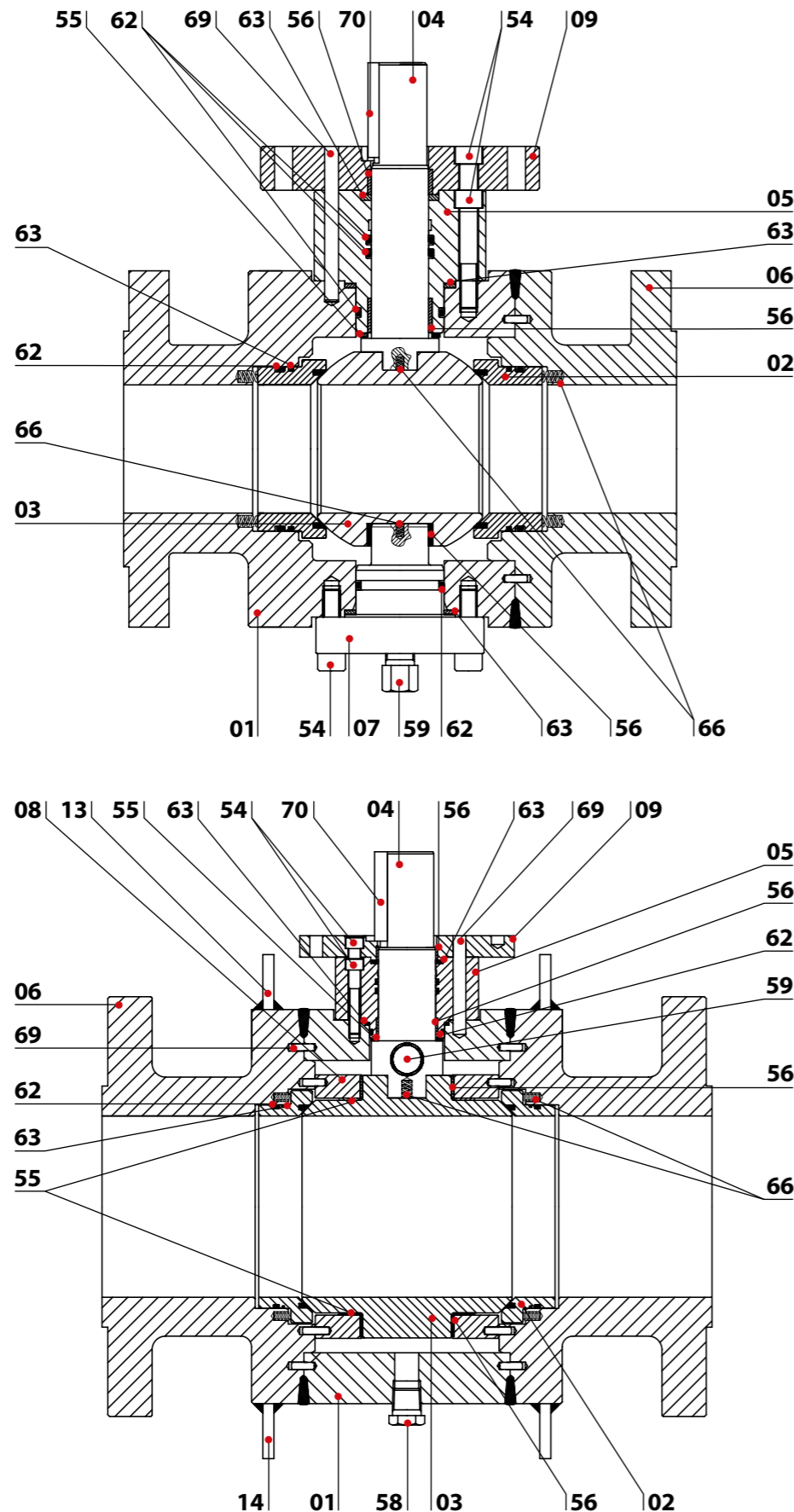

# ASME 150 - 300 - 600 - 900 - 1500 - 2500 Lbs

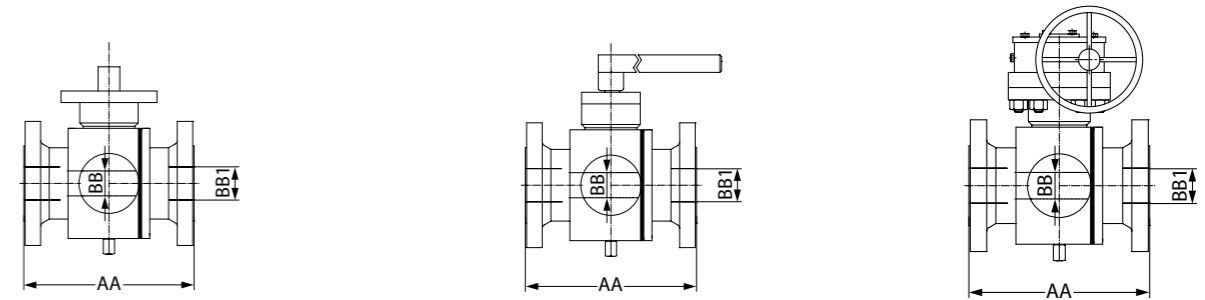

Full Bore DN	AA					Valve Approx. Weight (Kg)	Reduce Bore DN	AA					Valve Approx. Weight (Kg)
	RF	RTJ	BW	BB	BB1			RF	RTJ	BW	BB	BB1	
<b>Class 150</b>							<b>Class 150</b>						
1 1/2"	165	178	190	38	38	22	2"x 1 1/2"	178	190	216	38	49	26
2"	178	190	216	49	49	28	3"x 2"	203	216	283	49	74	31
3"	203	216	283	74	74	55	4"x 3"	229	241	305	74	100	63
4"	229	241	305	100	100	90	6"x 4"	394	406	457	100	150	102
<b>Class 300</b>							<b>Class 300</b>						
1 1/2"	190	203	190	38	38	25	2"x 1 1/2"	216	232	216	38	49	29
2"	216	232	216	49	49	29	3"x 2"	283	298	283	49	74	34
3"	283	298	283	74	74	57	4"x 3"	305	321	305	74	100	65
4"	305	321	305	100	100	110	6"x 4"	403	419	457	100	150	133
<b>Class 600</b>							<b>Class 600</b>						
1 1/2"	241	241	241	38	38	28	2"x 1 1/2"	292	295	292	38	49	33
2"	292	295	292	49	49	35	3"x 2"	356	359	356	49	74	40
3"	356	359	356	74	74	80	4"x 3"	432	435	432	74	100	102
4"	432	435	432	100	100	133	6"x 4"	559	562	559	100	150	165
<b>Class 900</b>							<b>Class 900</b>						
1 1/2"	305	305	305	38	38	40	2"x 1 1/2"	368	371	368	38	49	52
2"	368	371	368	49	49	53	3"x 2"	381	384	381	49	74	72
3"	381	384	381	74	74	93	4"x 3"	457	460	457	74	100	120
4"	457	460	457	100	100	170	6"x 4"	610	613	610	100	150	232
<b>Class 1500</b>							<b>Class 1500</b>						
1 1/2"	305	305	305	38	38	40	2"x 1 1/2"	368	371	368	38	49	52
2"	368	371	368	49	49	53	3"x 2"	470	473	470	49	74	75
3"	470	473	470	74	74	118	4"x 3"	546	549	546	74	100	143
4"	546	549	546	100	100	225	6"x 4"	705	711	705	100	144	300
<b>Class 2500</b>							<b>Class 2500</b>						
1 1/2"	387	387	387	38	38	48	2"x 1 1/2"	451	454	451	38	42	65
2"	451	454	451	42	42	93	3"x 2"	578	584	578	42	62	165
3"	578	584	578	62	62	215	4"x 3"	673	683	673	62	87	280
4"	673	683	673	87	87	385	6"x 4"	914	927	914	87	131	540

# API 2000 - 3000 - 5000 - 10000 psi

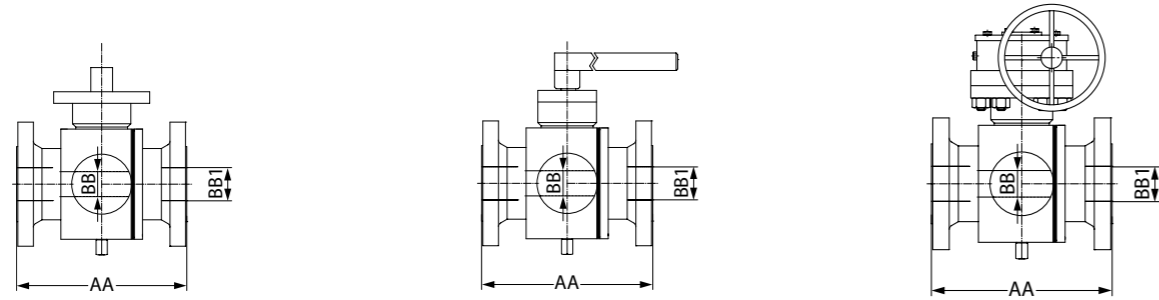

Full Bore DN	AA			Valve Approx. Weight (Kg)	Full Bore DN	AA			Valve Approx. Weight (Kg)
	RTJ					BB	BB1	RTJ	
<b>Class 2000</b>									
1" 13/16	241 (*)	46	46	28	2" 1/16 x 1" 13/16	295	46	52.4	30
2" 1/16	295	52.4	52.4	35	2" 9/16 x 2" 1/16	333	52.4	65.1	45
2" 9/16	333	65.1	65.1	55	3" 1/8 x 2" 9/16	359	65.1	79.4	70
3" 1/8	359	79.4	79.4	80	4" 1/16 x 3" 1/8	435	79.4	103.2	102
<b>Class 3000</b>									
1" 13/16	305 (*)	46	46	40	2" 1/16 x 1" 13/16	371	46	52.4	45
2" 1/2	371	52.4	52.4	55	2" 9/16 x 2" 1/16	422	52.4	65.1	60
2" 9/16	422	65.1	65.1	70	3" 1/8 x 2" 9/16	384	65.1	79.4	90
3" 1/8	384	79.4	79.4	95	4" 1/16 x 3" 1/8	460	79.4	103.2	120
<b>Class 5000</b>									
1" 13/16	371 (*)	46	46	40	2" 1/16 x 1" 13/16	371	46	52.4	45
2" 1/16	371	52.4	52.4	55	2" 9/16 x 2" 1/16	473	52.4	65.1	79
2" 9/16	473	65.1	65.1	85	3" 1/8 x 2" 9/16	473	65.1	79.4	118
3" 1/8	473	79.4	79.4	130	4" 1/16 x 3" 1/8	549	79.4	103.2	160
<b>Class 10000</b>									
1" 13/16	464	46	46	60	2" 1/16 x 1" 13/16	521	46	52.4	75
2" 1/16	521	52.4	52.4	170	2" 9/16 x 2" 1/16	565	52.4	65.1	185
2" 9/16	565	65.1	65.1	205	3" 1/16 x 2" 9/16	619	65.1	79.4	240
3" 1/16	619	77.8	77.8	330	4" 1/16 x 3" 1/16	670	77.8	103.2	370

\* (Manufacturer Standard)

# ASME 150 - 300 - 600 Lbs



Full Bore DN	AA					Valve Approx. Weight (Kg)	Reduce Bore DN	AA					Valve Approx. Weight (Kg)
	RF	RTJ	BW	BB	BB1			RF	RTJ	BW	BB	BB1	
<b>Class 150</b>													
6"	394	406	457	150	150	185	8"x6"	457	470	521	150	201	188
8"	457	470	521	201	201	270	10"x8"	533	546	559	201	252	290
10"	533	546	559	252	252	385	12"x10"	610	622	635	252	303	465
12"	610	622	635	303	303	562	14"x12"	686	698	762	303	334	562
14"	686	698	762	334	334	765	16"x14"	762	775	838	334	385	830
16"	762	775	838	385	385	1030	18"x16"	864	876	914	385	436	1080
18"	864	876	914	436	436	1218	20"x18"	914	927	991	436	487	1170
20"	914	927	991	487	487	1800	24"x20"	1067	1079	1143	487	589	1298
24"	1067	1079	1143	589	589	3097	30"x24"	1295	N/A	1397	589	735	1820
26"	1143	N/A	1245	633	633	3770	36"x30"	1524	N/A	1728	735	874	2048
28"	1245	N/A	1346	684	684	4635							
30"	1295	N/A	1397	735	735	5370							
32"	1372	N/A	1524	779	779	6960							
34"	1473	N/A	1626	830	830	7950							
36"	1524	N/A	1727	874	874	8950							
40"	1753	N/A	1956	976	976	12700							
<b>Class 300</b>													
6"	403	419	457	150	150	205	8"x6"	502	517	521	150	201	222
8"	502	517	521	201	201	310	10"x8"	568	584	559	201	252	297
10"	568	584	559	252	252	507	12"x10"	648	664	635	252	303	597
12"	648	664	635	303	303	740	14"x12"	762	778	762	303	334	820
14"	762	778	762	334	334	1038	16"x14"	838	854	838	334	385	1130
16"	838	854	838	385	385	1428	18"x16"	914	930	914	385	436	1598
18"	914	930	914	436	436	1602	20"x18"	991	1010	991	436	487	1797
20"	991	1010	991	487	487	2207	24"x20"	1143	1165	1143	487	589	2740
24"	1143	1165	1143	589	589	3470	30"x24"	1397	1422	1397	589	735	4630
26"	1245	1270	1245	633	633	4810	36"x30"	1727	1756	1727	735	874	8300
28"	1346	1372	1346	684	684	5920							
30"	1397	1422	1397	735	735	6740							
32"	1524	1553	1524	779	779	8050							
34"	1626	1654	1626	830	830	9260							
36"	1727	1756	1727	874	874	10200							
40"	1956	1956	1956	976	976	13950							
<b>Class 600</b>													
6"	559	562	559	150	150	255	8"x6"	660	664	660	150	201	290
8"	660	664	660	201	201	487	10"x8"	787	791	787	201	252	547
10"	787	791	787	252	252	760	12"x10"	838	841	838	252	303	810
12"	838	841	838	303	303	1070	14"x12"	889	892	889	303	334	1140
14"	889	892	889	334	334	1084	16"x14"	991	994	991	334	385	1360
16"	991	994	991	385	385	1527	18"x16"	1092	1095	1092	385	436	1682
18"	1092	1095	1092	436	436	2097	20"x18"	1194	1200	1194	436	487	2377
20"	1194	1200	1194	487	487	2640	24"x20"	1397	1406	1397	487	589	3250
24"	1397	1406	1397	589	589	4920	30"x24"	1651	1664	1651	589	735	5910
26"	1448	1460	1448	633	633	5820	36"x30"	2083	2098	2083	735	874	10540
28"	1549	1562	1549	684	684	6760							
30"	1651	1664	1651	735	735	8490							
32"	1778	1794	1778	779	779	9930							
34"	1930	1946	1930	830	830	11450							
36"	2083	2098	2083	874	874	13450							
40"	2337	2337	2337	976	976	18490							

# Top Entry

## Main Features

- Bolted Bonnet - Cast Body/Forged Bonnet and Trim (forged body available on request).
- Soft / Metal Seated.
- Self Relieving or Double Piston Effect Seat.
- Anti Blow-Out stem.
- Double Block & Bleed.
- Fire Safe API 6FA - API 607 ISO 14097.
- Antistatic device.
- Emergency sealant injection to stem & seats.
- Materials in accordance to NACE MR 01.75
- Above / below ground installation
- Full in-line maintenance, either with vertical and horizontal stem.

## Valve Parts

Pos.	Description
01	Body
02	Seat / Insert
03	Ball
04	Stem
05	Stem cover
05.1	Body Cover
07	Trunion
07B	Spacer Ring
09	Operator Flange
13	Lifting Lugs
20	Ring for Spring
51	Stud
52	Nut
54	Screw
55	Thrust Washer
56	Thrust Bearing
58	Plug
59	Bleeder
62	Seal
63	Gasket
66	Spring
69	Pin
70	Key

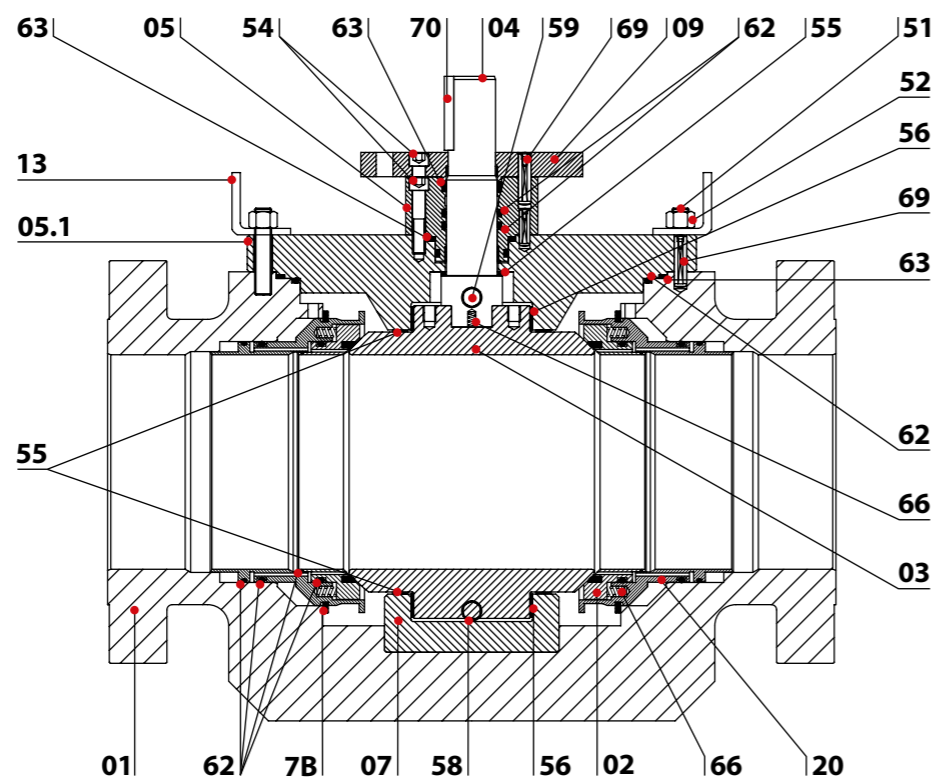
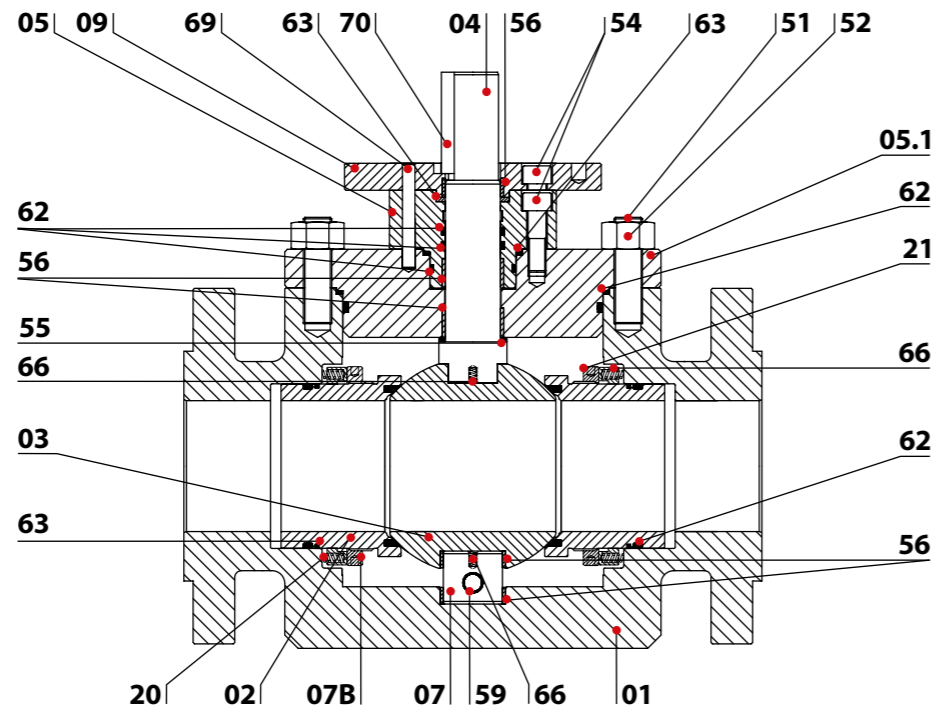

# ASME 150 - 300 - 600 - 900 - 1500 - 2500 Lbs

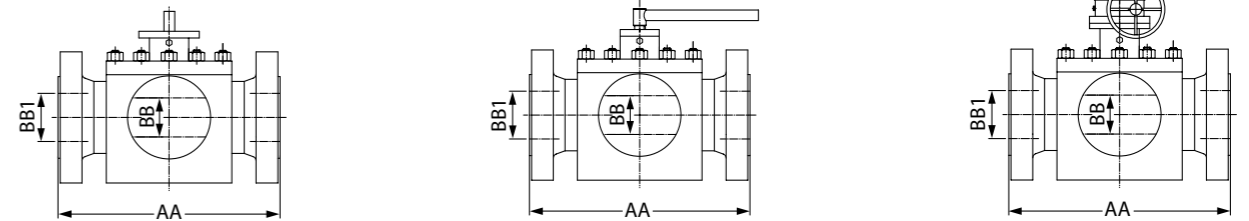

Full Bore DN	AA			BB	BB1	Valve Approx. Weight (Kg)
	RF	RTJ	BW			
<b>Class 150</b>						
1 1/2"	241	241	241	38	38	31
2"	292	295	292	49	49	39
3"	356	359	356	74	74	77
4"	432	435	432	100	100	126
<b>Class 300</b>						
1 1/2"	241	241	241	38	38	35
2"	292	295	292	49	49	41
3"	356	359	356	74	74	80
4"	432	435	432	100	100	154
<b>Class 600</b>						
1 1/2"	241	241	241	38	38	39
2"	292	295	292	49	49	49
3"	356	359	356	74	74	112
4"	432	435	432	100	100	186
<b>Class 900</b>						
1 1/2"	305	305	305	38	38	56
2"	368	371	368	49	49	74
3"	381	384	381	74	74	130
4"	457	460	457	100	100	238
<b>Class 1500</b>						
1 1/2"	305	305	305	38	38	56
2"	368	371	368	49	49	74
3"	470	473	470	74	74	165
4"	546	549	546	100	100	315
<b>Class 2500</b>						
1 1/2"	387	387	387	38	38	67
2"	451	454	451	42	42	130
3"	578	584	578	62	62	300
4"	673	683	673	87	87	539

Reduce Bore DN	AA			BB	BB1	Valve Approx. Weight (Kg)
	RF	RTJ	BW			
<b>Class 150</b>						
2"x1 1/2"	292	295	292	38	49	35
3"x2"	356	359	356	49	74	42
4"x3"	432	435	432	74	100	85
6"x4"	559	562	559	100	150	138
<b>Class 300</b>						
2"x1 1/2"	292	295	292	38	49	39
3"x2"	356	359	356	49	74	46
4"x3"	432	435	432	74	100	88
6"x4"	559	562	559	100	150	177
<b>Class 600</b>						
2"x1 1/2"	292	295	292	38	49	44
3"x2"	356	359	356	49	74	54
4"x3"	432	435	432	74	100	134
6"x4"	559	562	559	100	150	218
<b>Class 900</b>						
2"x1 1/2"	368	371	368	38	49	68
3"x2"	381	384	381	49	74	93
4"x3"	457	460	457	74	100	157
6"x4"	610	613	610	100	150	300
<b>Class 1500</b>						
2"x1 1/2"	368	371	368	38	49	68
3"x2"	470	473	470	49	74	96
4"x3"	546	549	546	74	100	190
6"x4"	705	711	705	100	144	390
<b>Class 2500</b>						
2"x1 1/2"	451	454	451	38	42	84
3"x2"	578	584	578	42	62	192
4"x3"	673	683	673	62	87	365
6"x4"	914	927	914	87	131	599

(Class ASME 150-300 face to face: in accordance with API 6D table 4 long pattern class ASME 600)

# API 2000 - 3000 - 5000 - 10000 psi

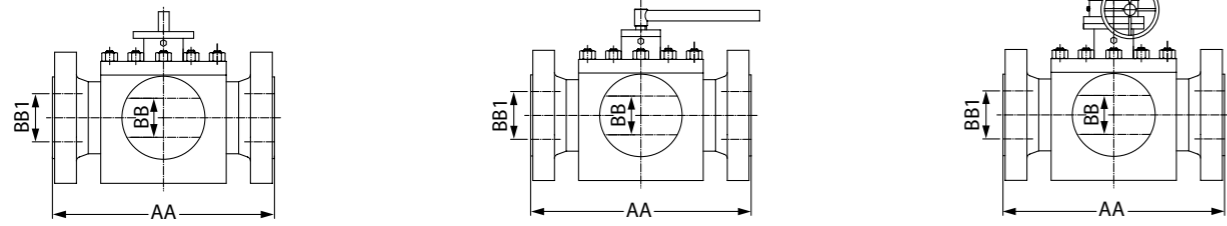

Full Bore DN	AA			Valve Approx. Weight (Kg)	Full Bore DN	AA			Valve Approx. Weight (Kg)				
	RTJ					BB	BB1	RTJ			BB	BB1	
<b>Class 2000</b>													
1" 13/16	241 (*)			46	46	39	2 1/16 x 1 13/16	295			46	52.4	41
2" 1/16	295			52.4	52.4	49	2 9/16 x 2 1/16	333			52.4	65.1	59
2 9/16	333			65.1	65.1	77	3 1/8 x 2 9/16	359			65.1	79.4	92
3 1/8	359			79.4	79.4	112	4 1/16 x 3 1/8	435			79.4	103.2	134
<b>Class 3000</b>													
1" 13/16	305 (*)			46	46	56	2 1/16 x 1 13/16	371			46	52.4	61
2" 1/16	371			52.4	52.4	77	2 9/16 x 2 1/16	422			52.4	65.1	82
2 9/16	422			65.1	65.1	98	3 1/8 x 2 9/16	384			65.1	79.4	118
3 1/8	384			79.4	79.4	133	4 1/16 x 3 1/8	460			79.4	103.2	158
<b>Class 5000</b>													
1" 13/16	371(*)			46	46	56	2 1/16 x 1 13/16	371			46	52.4	61
2" 1/16	371			52.4	52.4	77	2 9/16 x 2 1/16	473			52.4	65.1	101
2 9/16	473			65.1	65.1	165	3 1/8 x 2 9/16	473			65.1	79.4	195
3 1/8	473			79.4	79.4	182	4 1/16 x 3 1/8	549			79.4	103.2	212
<b>Class 10000</b>													
1" 13/16	464			46	46	84	2 1/16 x 1 13/16	521			46	52.4	99
2" 1/16	521			52.4	52.4	238	2 9/16 x 2 1/16	565			52.4	65.1	253
2 9/16	565			65.1	65.1	402	3 1/8 x 2 9/16	619			65.1	79.4	437
3 1/8	619			77.8	77.8	462	4 1/16 x 3 1/8	670			77.8	103.2	502

\*(Manufacturer Standard)

# ASME 150 - 300 - 600 Lbs



Full Bore DN	AA				Valve Approx. Weight (Kg)	Reduce Bore DN	AA				Valve Approx. Weight (Kg)		
	RF	RTJ	BW	BB			BB1	RF	RTJ	BW		BB	BB1
<b>Class 150</b>													
6"	559	562	559	150	150	278	8"x6"	660	664	660	150	201	282
8"	660	664	660	201	201	405	10"x8"	787	791	787	201	252	435
10"	787	791	787	252	252	578	12"x10"	838	841	838	252	303	698
12"	838	841	838	303	303	843	14"x12"	889	892	889	303	334	843
14"	889	892	889	334	334	1147	16"x14"	991	994	991	334	385	1245
16"	991	994	991	385	385	1545	18"x16"	1092	1095	1092	385	436	1620
18"	1092	1095	1092	436	436	1830	20"x18"	1194	1200	1194	436	487	1755
20"	1194	1200	1194	487	487	2700	24"x20"	1397	1406	1397	487	589	1947
24"	1397	1406	1397	589	589	4650	30"x24"	1651	1664	1651	589	735	2730
26"	1448	1460	1448	633	633	5655	36"x30"	2083	2098	2083	735	874	3072
28"	1549	1562	1549	684	684	6955							
30"	1651	1664	1651	735	735	8055							
32"	1778	1794	1778	779	779	10440							
34"	1930	1946	1930	830	830	12000							
36"	2083	2098	2083	874	874	13450							
40"	2337	2337	2337	976	976	19050							
<b>Class 300</b>													
6"	559	562	559	150	150	308	8"x6"	660	664	660	150	201	333
8"	660	664	660	201	201	465	10"x8"	787	791	787	201	252	446
10"	787	791	787	252	252	761	12"x10"	838	841	838	252	303	900
12"	838	841	838	303	303	1110	14"x12"	889	892	889	303	334	1230
14"	889	892	889	334	334	1557	16"x14"	991	994	991	334	385	1695
16"	991	994	991	385	385	2142	18"x16"	1092	1095	1092	385	436	2397
18"	1092	1095	1092	436	436	2403	20"x18"	1194	1200	1194	436	487	2696
20"	1194	1200	1194	487	487	3310	24"x20"	1397	1406	1397	487	589	4110
24"	1397	1406	1397	589	589	5205	30"x24"	1651	1664	1651	589	735	6945
26"	1448	1460	1448	633	633	7215	36"x30"	2083	2098	2083	735	874	12450
28"	1549	1562	1549	684	684	8880							
30"	1651	1664	1651	735	735	10110							
32"	1778	1794	1778	779	779	12075							
34"	1930	1946	1930	830	830	13890							
36"	2083	2098	2083	874	874	15300							
40"	2337	2337	2337	976	976	20925							
<b>Class 600</b>													
6"	559	562	559	150	150	382	8"x6"	660	664	660	150	201	435
8"	660	664	660	201	201	730	10"x8"	787	791	787	201	252	820
10"	787	791	787	252	252	1140	12"x10"	838	841	838	252	303	1215
12"	838	841	838	303	303	1605	14"x12"	889	892	889	303	334	1710
14"	889	892	889	334	334	1628	16"x14"	991	994	991	334	385	2040
16"	991	994	991	385	385	2290	18"x16"	1092	1095	1092	385	436	2523
18"	1092	1095	1092	436	436	3145	20"x18"	1194	1200	1194	436	487	3570
20"	1194	1200	1194	487	487	3960	24"x20"	1397	1406	1397	487	589	4880
24"	1397	1406	1397	589	589	7135	30"x24"	1651	1664	1651	589	735	8860
26"	1448	1460	1448	633	633	8730	36"x30"	2083	2098	2083	735	874	15810
28"	1549	1562	1549	684	684	10140							
30"	1651	1664	1651	735	735	12730							
32"	1778	1794	1778	779	779	14800							
34"	1930	1946	1930	830	830	17175							
36"	2083	2098	2083	874	874	20175							
40"	2337	2337	2337	976	976	27735							

(Class ASME 150-300 face to face: in accordance with API 6D table 4 long pattern class ASME 600)



# ASME 900 - 1500 - 2500 Lbs



Full Bore DN	AA			BB	BB1	Valve Approx. Weight (Kg)
	RF	RTJ	BW			
<b>Class 900</b>						
6"	610	613	610	150	150	550
8"	737	740	737	201	201	900
10"	838	841	838	252	252	1540
12"	965	968	965	303	303	2340
14"	1029	1038	1029	322	322	2220
16"	1130	1140	1130	373	373	3240
18"	1219	1232	1219	423	423	4290
20"	1321	1333	1321	471	471	6330
24"	1549	1568	1549	570	570	10275
<b>Class 1500</b>						
6"	705	711	705	144	144	728
8"	832	841	832	192	192	1240
10"	991	1000	991	239	239	2260
12"	1130	1146	1130	287	287	3408
14"	1257	1276	1257	315	315	4320
16"	1384	1406	1384	360	360	6180
18"	1537	1559	1537	406	406	9390
20"	1664	1686	1664	454	454	13680
24"	2043	2071	2043	546	546	21480
<b>Class 2500</b>						
6"	914	927	914	131	131	1245
8"	1022	1038	1022	179	179	2150
10"	1270	1292	1270	223	223	3330
12"	1422	1445	1422	265	265	5020

Reduce Bore DN	AA			BB	BB1	Valve Approx. Weight (Kg)
	RF	RTJ	BW			
<b>Class 900</b>						
8"x6"	737	740	737	150	201	671
10"x8"	838	841	838	201	252	1050
12"x10"	965	968	965	252	303	1725
14"x12"	1029	1038	1029	303	322	2464
16"x14"	1130	1140	1130	322	373	2580
18"x16"	1219	1232	1219	373	423	3660
20"x18"	1321	1333	1321	423	471	4890
24"x20"	1549	1568	1549	471	570	8145
<b>Class 1500</b>						
8"x6"	832	841	832	144	192	862
10"x8"	991	1000	991	192	239	1548
12"x10"	1130	1146	1130	239	287	2650
14"x12"	1257	1276	1257	287	315	3800
16"x14"	1384	1406	1384	315	360	4920
18"x16"	1537	1559	1537	360	406	7470
20"x18"	1664	1686	1664	406	454	11310
24"x20"	2043	2071	2043	454	546	16425
<b>Class 2500</b>						
8"x6"	1022	1038	1022	131	179	1725
10"x8"	1270	1292	1270	179	223	2625
12"x10"	1422	1445	1422	223	265	3975

# API 2000 - 3000 - 5000 - 10000 psi

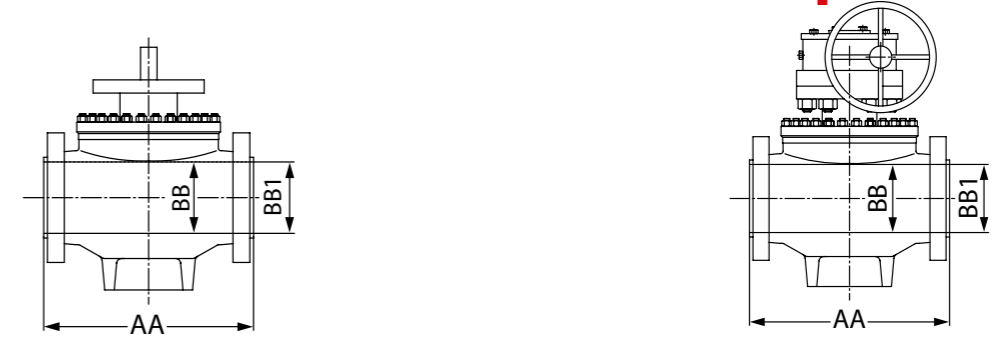

Full Bore DN	AA		BB	BB1	Valve Approx. Weight (Kg)
	RTJ				
<b>Class 2000</b>					
4" 1/16	435		103.2	103.2	210
5" 1/8	562		130.2	130.2	330
7" 1/16	740(*)		179.4	179.4	420
<b>Class 3000</b>					
4" 1/16	460		103.2	103.2	293
5" 1/8	613(*)		130.2	130.2	675
7" 1/16	714		179.4	179.4	1155
<b>Class 5000</b>					
4" 1/16	549		103.2	103.2	307.5
5" 1/8	727(*)		130.2	130.2	840
7" 1/16	813(*)		179.4	179.4	1275
<b>Class 10000</b>					
4" 1/16	670		103.2	103.2	645
5" 1/8	737		130.2	130.2	1275
7" 1/16	889		179.4	179.4	2220

Full Bore DN	AA		BB	BB1	Valve Approx. Weight (Kg)
	RTJ				
<b>Class 2000</b>					
5" 1/8 x 4" 1/16	562		103.2	130.2	278
7" 1/16 x 5" 1/8	740		130.2	179.4	360
<b>Class 3000</b>					
5" 1/8 x 4" 1/16	613(*)		103.2	103.2	390
7" 1/16 x 5" 1/8	714		130.2	179.4	720
<b>Class 5000</b>					
5" 1/8 x 4" 1/16	727(*)		103.2	130.2	450
7" 1/16 x 5" 1/8	813(*)		130.2	179.4	930
<b>Class 10000</b>					
5" 1/8 x 4" 1/16	737		103.2	130.2	765
7" 1/16 x 5" 1/8	889		130.2	179.4	1870

\*(Manufacturer Standard)

# Double Block & Bleed

## Main Features

- Bolted Body-All Forged Construction.
- Split Body.
- Soft / Metal Seated.
- Self Relieving or Double Piston Effect Seat
- Anti Blow-Out stem.
- Bleed Type (Needle or Globe valve).
- Fire safe API 6FA - API 607 ISO 14097.
- Antistatic device.
- Emergency sealant injection to stem & seat.
- Materials in accordance to NACE MR 01.75
- Above ground installation.

## Valve Parts

Pos.	Description
01	Body
02	Seat / Insert
03	Ball
04	Stem
05	Stem cover
06	Flange
07	Trunnion
08	Ball Support
09	Operator Flange
13	Lifting Lugs
14	Valve Support
51	Stud
52	Nut
54	Screw
55	Thrust Washer
56	Thrust Bearing
58	Plug
59	Bleeder
62	Seal
63	Gasket
66	Spring
69	Pin
70	Key

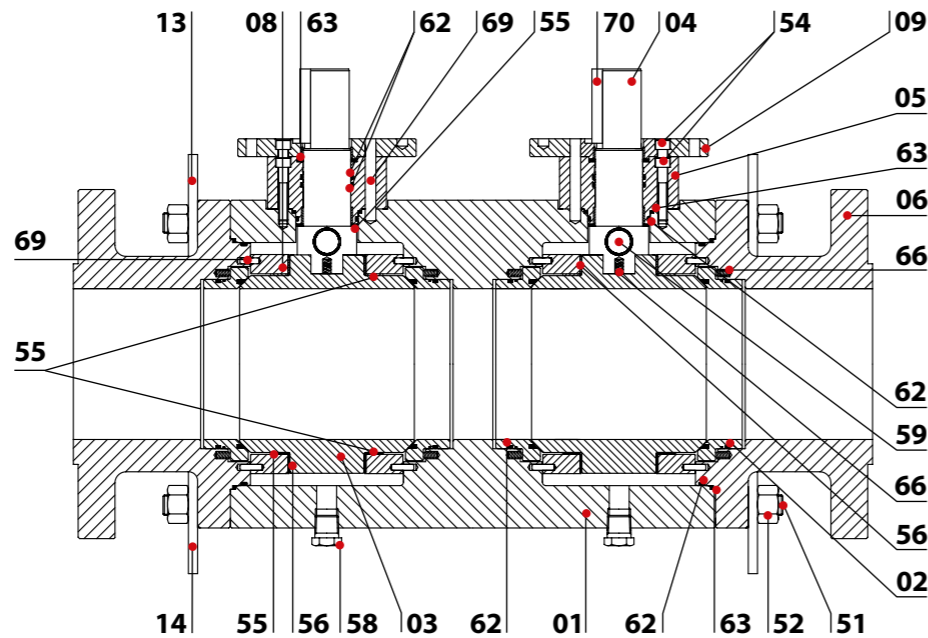
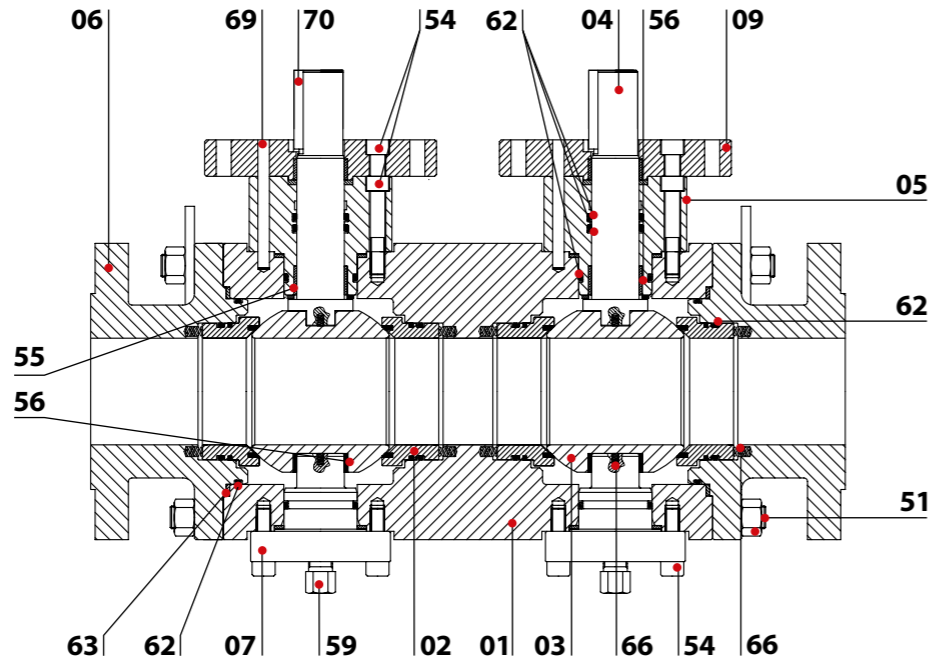

# Double Block & Bleed

## Main Features

- Bolted Bonnet - Cast Body/Forged Bonnet and Trim (forged body available on request).
- Soft / Metal Seated.
- Self Relieving or Double Piston Effect Seat
- Anti Blow-Out stem.
- Bleed Type (Needle or Globe valve).
- Fire safe API 6FA - API 607 ISO 14097.
- Antistatic device.
- Emergency sealant injection to stem & seat.
- Materials in accordance to NACE MR 01.75.
- Above ground installation
- Full In-Line Maintenance either with vertical and horizontal stem.

## Valve Parts

Pos.	Description
01	Body
02	Seat / Insert
03	Ball
04	Stem
05	Stem cover
05.1	Body Cover
07	Trunnion
7B	Spacer Ring
09	Operator Flange
13	Lifting Lugs
20	Ring for Spring
51	Stud
52	Nut
54	Screw
55	Thrust Washer
56	Thrust Bearing
58	Plug
59	Bleeder
62	Seal
63	Gasket
66	Spring
69	Pin
70	Key

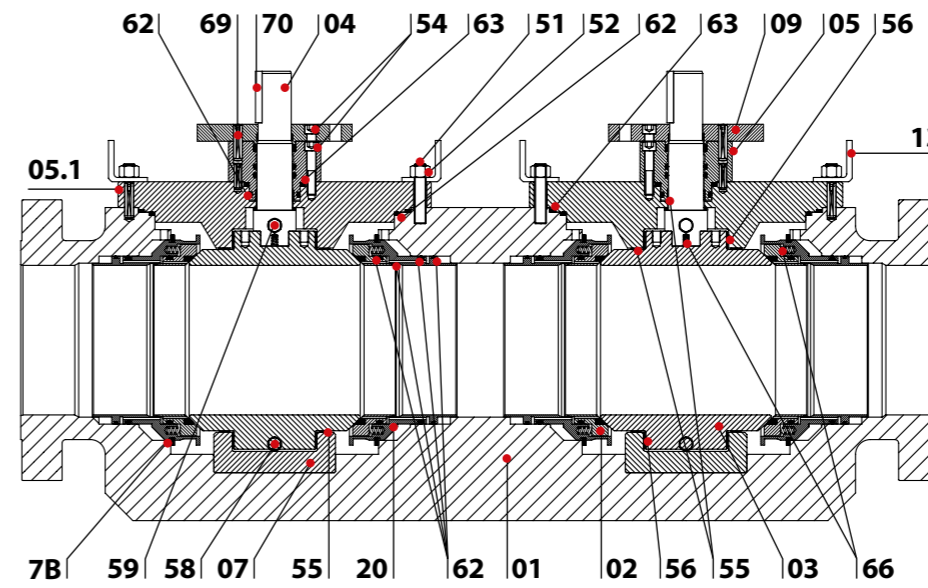
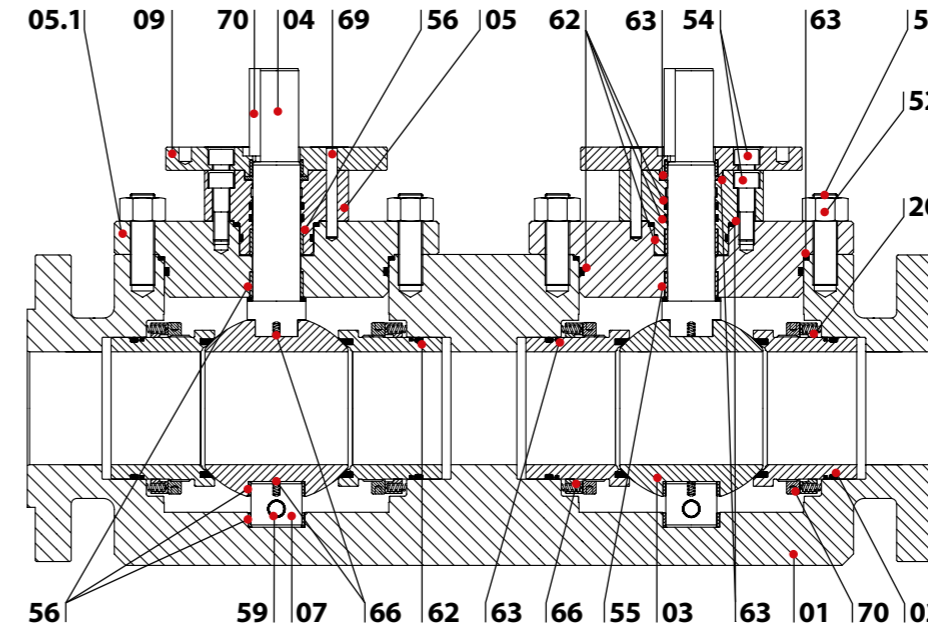

## Bleed Types



# ASME 150 - 300 - 600 - 900 - 1500 - 2500 Lbs

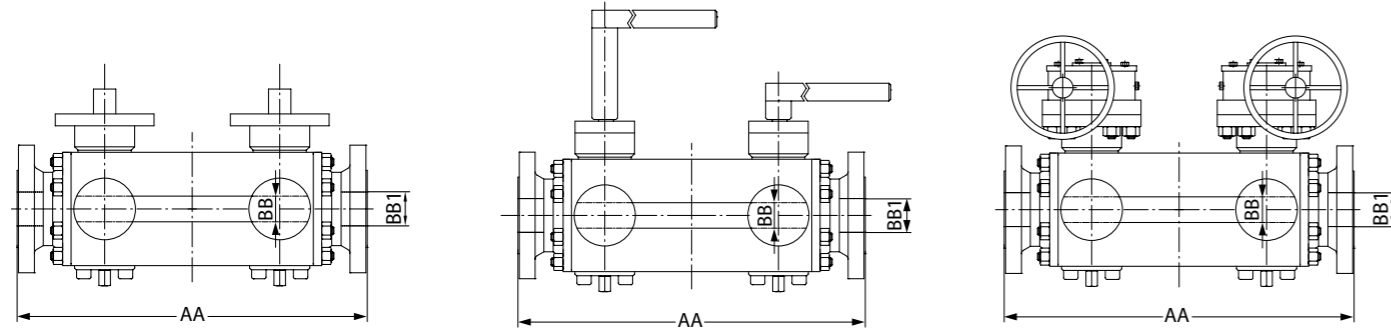

Full Bore DN	AA			BB	BB1	Valve Approx. Weight (Kg)	Reduce Bore DN	AA			Valve Approx. Weight (Kg)		
	RF	RTJ	BW					RF	RTJ	BW		BB	BB1
<b>Class 150</b>													
1 1/2"	320	320	360	38	38	35	2"x 1 1/2"	350	363	375	38	51	39
2"	350	363	375	51	51	45	3"x 2"	410	423	480	51	77	48
3"	410	423	480	74	74	88	4"x 3"	455	468	530	77	102	96
4"	455	468	530	102	102	144	6"x 4"	630	642	690	102	152	156
<b>Class 300</b>													
1 1/2"	360	360	360	38	38	40	2"x 1 1/2"	375	391	375	38	51	44
2"	375	391	375	51	51	47	3"x 2"	480	496	480	51	77	52
3"	480	496	480	77	77	92	4"x 3"	530	546	530	77	102	100
4"	530	546	530	102	102	176	6"x 4"	690	706	690	102	152	199
<b>Class 600</b>													
1 1/2"	410	410	410	38	38	45	2"x 1 1/2"	450	453	450	38	51	50
2"	450	453	450	51	51	56	3"x 2"	550	553	550	51	77	61
3"	550	553	550	77	77	128	4"x 3"	685	688	685	77	102	150
4"	685	688	685	102	102	213	6"x 4"	800	803	800	102	152	245
<b>Class 900</b>													
1 1/2"	475	475	475	38	38	64	2"x 1 1/2"	535	538	535	38	51	76
2"	535	538	535	51	51	85	3"x 2"	585	588	585	51	77	104
3"	585	588	585	77	77	149	4"x 3"	690	693	690	77	102	176
4"	690	693	690	102	102	272	6"x 4"	890	893	890	102	152	334
<b>Class 1500</b>													
1 1/2"	475	475	475	38	38	64	2"x 1 1/2"	535	538	535	38	51	76
2"	535	538	535	51	51	85	3"x 2"	675	678	675	51	77	112
3"	675	678	675	77	77	189	4"x 3"	780	783	780	77	102	214
4"	780	783	780	102	102	360	6"x 4"	970	976	970	102	146	435
<b>Class 2500</b>													
1 1/2"	610	610	610	38	38	77	2"x 1 1/2"	640	643	640	38	44.5	95
2"	640	643	640	44.5	44.5	149	3"x 2"	905	911	905	44.5	63.5	222
3"	905	911	905	63.5	63.5	344	4"x 3"	940	950	940	63.5	89	409
4"	940	950	940	89	89	616	6"x 4"	1250	1263	1250	89	133	671

Dimension AA = Manufacturer Standard

# API 2000 - 3000 - 5000 - 10000 psi

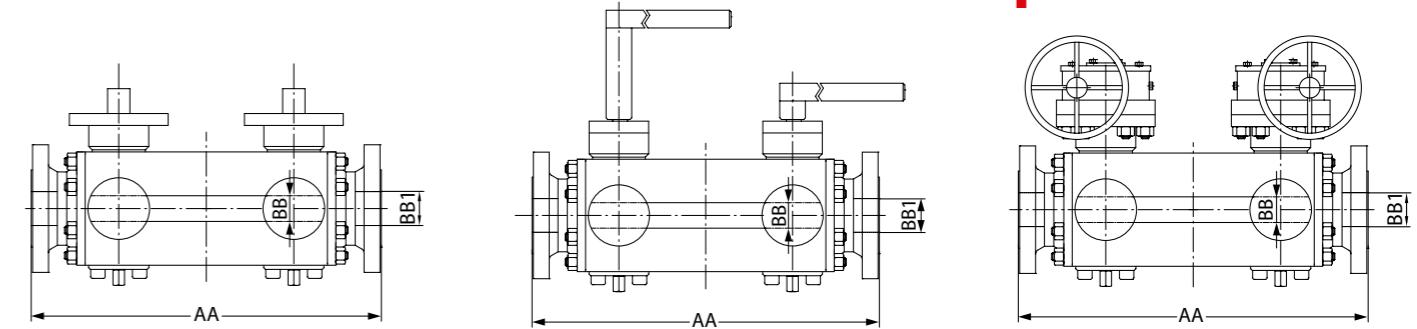

Full Bore DN	AA			Valve Approx. Weight (Kg)	Full Bore DN	AA			Valve Approx. Weight (Kg)
	RTJ					BB	BB1	BB	
<b>Class 2000</b>									
1 13/16"	453			46	2 1/16" x 1 13/16"	453			47
2 1/16"	453			52.4	2 9/16" x 2 1/16"	528			66
2 9/16"	528			65.1	3 1/8" x 2 9/16"	553			103
3 1/8"	553			79.4	4 1/16" x 3 1/8"	688			140
<b>Class 3000</b>									
1 13/16"	538			46	2 1/16" x 1 13/16"	538			69
2 1/16"	538			52.4	2 9/16" x 2 1/16"	678			93
2 9/16"	678			65.1	3 1/8" x 2 9/16"	678			132
3 1/8"	678			79.4	4 1/16" x 3 1/8"	693			177
<b>Class 5000</b>									
1 13/16"	538			46	2 1/16" x 1 13/16"	538			72
2 1/16"	538			52.4	2 9/16" x 2 1/16"	678			127
2 9/16"	678			65.1	3 1/8" x 2 9/16"	678			136
3 1/8"	678			79.4	4 1/16" x 3 1/8"	783			256
<b>Class 10000</b>									
1 13/16"	643			46	2 1/16" x 1 13/16"	643			120
2 1/16"	643			52.4	2 9/16" x 2 1/16"	911			296
2 9/16"	911			65.1	3 1/8" x 2 9/16"	950			384
3 1/8"	950			77.8	4 1/16" x 3 1/8"	1263			592

Dimension AA = Manufacturer Standard

# ASME 150 - 300 - 600 Lbs

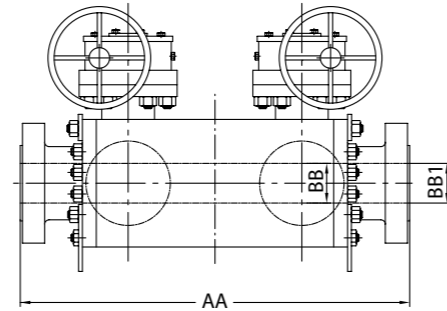
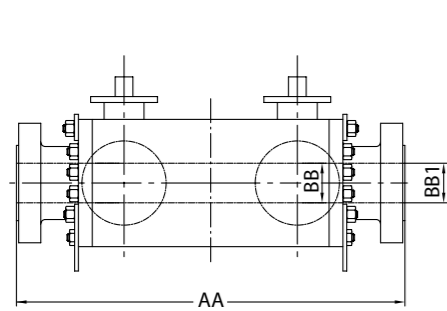

Full Bore DN	AA			BB	BB1	Valve Approx. Weight (Kg)
	RF	RTJ	BW			
<b>Class 150</b>						
6"	700	712	720	150	150	296
8"	810	823	850	201	201	432
10"	960	973	990	252	252	462
12"	1110	1122	1150	303	303	899
14"	1220	1232	1300	334	334	1224
16"	1370	1383	1460	385	385	1648
18"	1570	1582	1620	436	436	1950
20"	1700	1713	1770	487	487	2880
24"	1990	2002	2070	589	589	4955
26"	2200	N/A	2260	633	633	6032
28"	2330	N/A	2440	684	684	7416
30"	2490	N/A	2560	735	735	8055
32"	2620	N/A	2770	779	779	11136
34"	2800	N/A	2930	830	830	12720
36"	2930	N/A	3120	874	874	14320
40"	3340	N/A	3520	976	976	20320

Reduce Bore DN	AA			BB	BB1	Valve Approx. Weight (Kg)
	RF	RTJ	BW			
<b>Class 150</b>						
8"x6"	810	823	850	150	201	300
10"x8"	960	973	990	201	252	464
12"x10"	1110	1122	1150	252	303	744
14"x12"	1220	1232	1300	303	334	899
16"x14"	1370	1383	1460	334	385	1328
18"x16"	1570	1582	1620	385	436	1728
20"x18"	1700	1713	1770	436	487	1872
24"x20"	1990	2002	2070	487	589	2077
30"x24"	2490	N/A	2560	589	735	2912
36"x30"	2930	N/A	3120	735	874	3280

Full Bore DN	AA			BB	BB1	Valve Approx. Weight (Kg)
	RF	RTJ	BW			
<b>Class 300</b>						
6"	720	736	720	150	150	328
8"	850	865	850	201	201	496
10"	990	1006	990	252	252	811
12"	1150	1166	1150	303	303	1184
14"	1300	1316	1300	334	334	1660
16"	1460	1476	1460	385	385	2290
18"	1620	1636	1620	436	436	2563
20"	1770	1789	1770	487	487	3531
24"	2070	2092	2070	589	589	5552
26"	2260	2285	2260	633	633	7696
28"	2440	2466	2440	684	684	9472
30"	2560	2585	2560	735	735	10740
32"	2770	2799	2770	779	779	12880
34"	2930	2958	2930	830	830	14820
36"	3120	3149	3120	874	874	16320
40"	3520	3520	3520	976	976	22320

Reduce Bore DN	AA			BB	BB1	Valve Approx. Weight (Kg)
	RF	RTJ	BW			
<b>Class 300</b>						
8"x6"	850	865	850	150	201	355
10"x8"	990	1006	990	201	252	475
12"x10"	1150	1166	1150	252	303	955
14"x12"	1300	1316	1300	303	334	1312
16"x14"	1460	1476	1460	334	385	1808
18"x16"	1620	1636	1620	385	436	2557
20"x18"	1770	1789	1770	436	487	2875
24"x20"	2070	2092	2070	487	589	4384
30"x24"	2560	2585	2560	589	735	7408
36"x30"	3120	3149	3120	735	874	13280

Full Bore DN	AA			BB	BB1	Valve Approx. Weight (Kg)
	RF	RTJ	BW			
<b>Class 600</b>						
6"	860	863	860	150	150	408
8"	1010	1014	1010	201	201	779
10"	1210	1214	1210	252	252	1216
12"	1330	1333	1330	303	303	1712
14"	1430	1433	1430	334	334	1736
16"	1620	1623	1620	385	385	2443
18"	1800	1803	1800	436	436	3355
20"	1970	1976	1970	487	487	4230
24"	2350	2359	2350	589	589	7608
26"	2480	2492	2480	633	633	9312
28"	2650	2663	2650	684	684	10815
30"	2830	2843	2830	735	735	13584
32"	3020	3036	3020	779	779	15888
34"	3260	3276	3260	830	830	18320
36"	3480	3495	3480	874	874	21520
40"	3940	3940	3940	976	976	29580

Reduce Bore DN	AA			BB	BB1	Valve Approx. Weight (Kg)
	RF	RTJ	BW			
<b>Class 600</b>						
8"x6"	1010	1014	1010	150	201	464
10"x8"	1210	1214	1210	201	252	875
12"x10"	1330	1333	1330	252	303	1296
14"x12"	1430	1433	1430	303	334	1824
16"x14"	1620	1623	1620	334	385	2176
18"x16"	1800	1803	1800	385	436	2691
20"x18"	1970	1976	1970	436	487	3803
24"x20"	2350	2359	2350	487	589	5200
30"x24"	2830	2843	2830	589	735	9460
36"x30"	3480	3495	3480	735	874	16850

Dimension AA = Manufacturer Standard

# ASME 900 - 1500 - 2500 Lbs

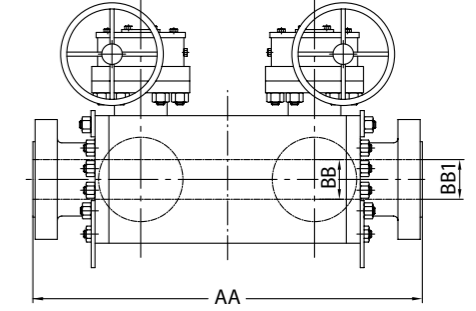
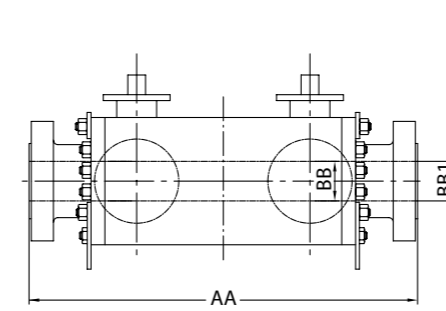

Full Bore DN	AA			BB	BB1	Valve Approx. Weight (Kg)
	RF	RTJ	BW			
<b>Class 900</b>						
6"	950	953	950	150	150	587
8"	1075	1078	1075	201	201	960
10"	1260	1263	1260	252	252	1645
12"	1475	1478	1475	303	303	2492
14"	1570	1579	1570	322	322	2363
16"	1760	1770	1760	373	373	3451
18"	1940	1953	1940	423	423	4576
20"	2110	2122	2110	471	471	6752
24"	2520	2539	2520	570	570	10950

Reduce Bore DN	AA			BB	BB1	Valve Approx. Weight (Kg)
	RF	RTJ	BW			
<b>Class 900</b>						
8"x6"	1075	1078	1075	150	201	715
10"x8"	1260	1263	1260	201	252	1120
12"x10"	1475	1478	1475	252	303	1837
14"x12"	1570	1579	1570	303	322	2628
16"x14"	1760	1770	1760	322	373	2747
18"x16"	1940	1953	1940	373	423	3898
20"x18"	2110	2122	2110	423	471	5216
24"x20"	2520	2539	2520	471	570	8688
-	-	-	-	-	-	-

Full Bore DN	AA			BB	BB1	Valve Approx. Weight (Kg)
	RF	RTJ	BW			
<b>Class 1500</b>						
6"	1050	1056	1050	144	144	776
8"	1230	1239	1230	192	192	1323
10"	1480	1489	1480	239	239	2411
12"	1660	1676	1660	287	287	3635
14"	1840	1859	1840	315	315	4608
16"	2040	2062	2040	360	360	6592
18"	2270	2292	2270	406	406	10015
20"	2510	2532	2510	454	454	14592
24"	3040	3068	3040	546	546	22912

Reduce Bore DN	AA			BB	BB1	Valve Approx. Weight (Kg)
	RF	RTJ	BW			
<b>Class 1500</b>						
8"x6"	1230	1239	1230	144	192	920
10"x8"	1480	1489	1480	192	239	1651
12"x10"	1660	1676	1660	239	287	2827
14"x12"	1840	1859	1840	287	315	4059
16"x14"	2040	2062	2040	315	360	5248
18"x16"	2270	2292	2270	360	406	7970
20"x18"	2510	2532	2510	406	454	12065
24"x20"	3040	3068	3040	454	546	17520
-	-	-	-	-	-	-

Full Bore DN	AA			BB	BB1	Valve Approx. Weight (Kg)
	RF	RTJ	BW			
<b>Class 2500</b>						
6"	1310	1323	1310	131	131	1328
8"	1460	1476	1460	179	179	2296
10"	1770	1792	1770	223	223	3552
12"	1960	1983	1960	265	265	5360

Reduce Bore DN	AA			BB	BB1	Valve Approx. Weight (Kg)
	RF	RTJ	BW			
<b>Class 2500</b>						
8"x6"	1460	1476	1460	131	179	1840
10"x8"	1770	1792	1770	179	223	2800
12"x10"	1960	1983	1960	223	265	4240
-	-	-	-	-	-	-

Dimension AA = Manufacturer Standard



# API 2000 - 3000 - 5000 - 10000 Lbs

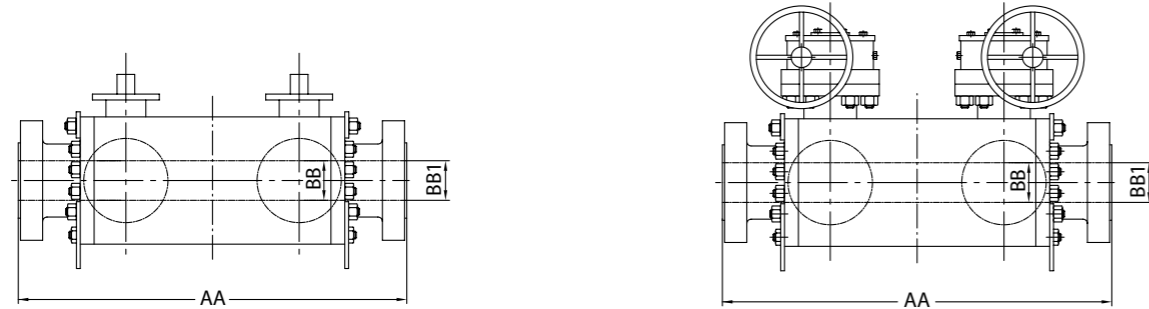

Full Bore DN	AA			Valve Approx. Weight (Kg)
	RTJ	BB	BB1	
<b>Class 2000</b>				
4" 1/16	688	103.2	103.2	224
5" 1/8	863	130.2	130.2	352
7" 1/16	1110	179.4	179.4	448
<b>Class 3000</b>				
4" 1/16	693	103.2	103.2	312
5" 1/8	953	130.2	130.2	720
7" 1/16	953	179.4	179.4	1232
<b>Class 5000</b>				
4" 1/16	783	103.2	103.2	328
5" 1/8	1090	130.2	130.2	896
7" 1/16	1140	179.4	179.4	1360
<b>Class 10000</b>				
4" 1/16	1005	103.2	103.2	688
5" 1/8	1220	130.2	130.2	1350
7" 1/16	1490	179.4	179.4	2365

Full Bore DN	AA			Valve Approx. Weight (Kg)
	RTJ	BB	BB1	
<b>Class 2000</b>				
5" 1/8 x 4" 1/16	863	103.2	130.2	296
7" 1/16 x 5" 1/8	1110	130.2	179.4	384
-	-	-	-	-
<b>Class 3000</b>				
5" 1/8 x 4" 1/16	953	103.2	130.2	416
7" 1/16 x 5" 1/8	953	130.2	179.4	768
<b>Class 5000</b>				
5" 1/8 x 4" 1/16	1090	103.2	130.2	480
7" 1/16 x 5" 1/8	1140	130.2	179.4	992
-	-	-	-	-
<b>Class 10000</b>				
5" 1/8 x 4" 1/16	1220	103.2	130.2	816
7" 1/16 x 5" 1/8	1490	130.2	179.4	2005
-	-	-	-	-

Dimension AA = Manufacturer Standard

# ASME 150-300 - 600 - 900 - 1500 - 2500 Lbs

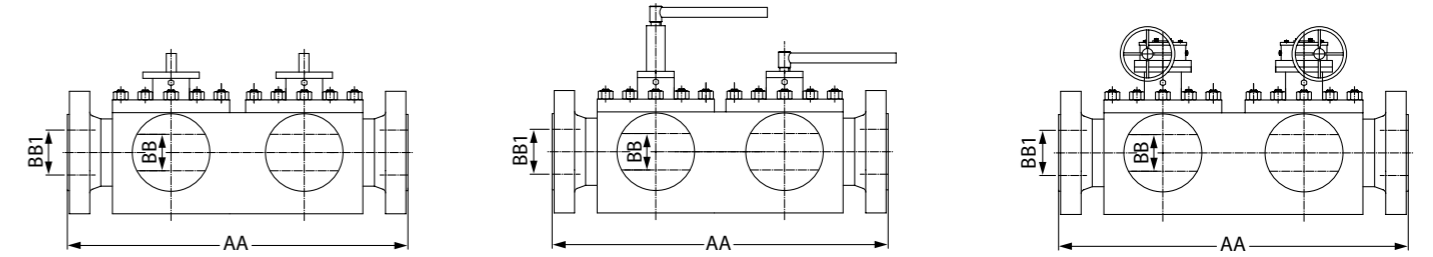

Full Bore DN	AA					Valve Approx. Weight (Kg)
	RF	RTJ	BW	BB	BB1	
<b>Class 150</b>						
1" 1/2	495	495	495	38	38	75
2"	540	543	540	49	49	95
3"	660	663	660	74	74	215
4"	820	823	820	100	100	358
<b>Class 300</b>						
1" 1/2	495	495	495	38	38	75
2"	540	543	540	49	49	95
3"	660	663	660	74	74	215
4"	820	823	820	100	100	358
<b>Class 600</b>						
1" 1/2	495	495	495	38	38	75
2"	540	543	540	49	49	95
3"	660	663	660	74	74	215
4"	820	823	820	100	100	358
<b>Class 900</b>						
1" 1/2	570	570	570	38	38	107
2"	645	648	645	49	49	142
3"	700	703	700	74	74	250
4"	830	833	830	100	100	455
<b>Class 1500</b>						
1" 1/2	570	570	570	38	38	107
2"	645	648	645	49	49	142
3"	810	813	810	74	74	198
4"	935	938	935	100	100	378
<b>Class 2500</b>						
1" 1/2	730	730	730	38	38	129
2"	770	773	770	42	42	250
3"	1085	1091	1085	62	62	575
4"	1125	1135	1125	87	87	1035

Reduce Bore DN	AA					Valve Approx. Weight (Kg)
	RF	RTJ	BW	BB	BB1	
<b>Class 150</b>						
2" x 1" 1/2	540	543	540	38	49	53
3" x 2"	660	663	660	49	74	65
4" x 3"	820	823	820	74	100	161
6" x 4"	960	963	960	100	150	418
<b>Class 300</b>						
2" x 1" 1/2	540	543	540	38	49	53
3" x 2"	660	663	660	49	74	65
4" x 3"	820	823	820	74	100	161
6" x 4"	960	963	960	100	150	418
<b>Class 600</b>						
2" x 1" 1/2	540	543	540	38	49	53
3" x 2"	660	663	660	49	74	65
4" x 3"	820	823	820	74	100	161
6" x 4"	960	963	960	100	150	418
<b>Class 900</b>						
2" x 1" 1/2	645	648	645	38	49	82
3" x 2"	700	703	700	49	74	112
4" x 3"	830	833	830	74	100	189
6" x 4"	1070	1073	1070	100	150	576
<b>Class 1500</b>						
2" x 1" 1/2	645	648	645	38	49	82
3" x 2"	810	813	810	49	74	115
4" x 3"	935	938	935	74	100	228
6" x 4"	1165	1171	1165	100	144	749
<b>Class 2500</b>						
2" x 1" 1/2	770	773	770	38	42	101
3" x 2"	1085	1091	1085	42	62	230
4" x 3"	1125	1135	1125	62	87	438
6" x 4"	1500	1513	1500	87	131	1152

Dimension AA = Manufacturer Standard

# API 2000 - 3000 - 5000 - 10000 psi

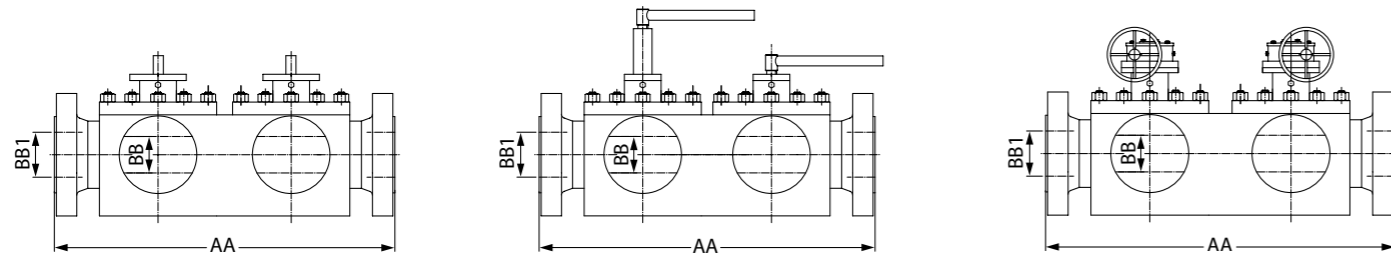

Full Bore DN	AA		BB	BB1	Valve Approx. Weight (Kg)
	RTJ				
<b>Class 2000</b>					
1" 13/16	545		46	46	76
2" 1/16	545		52.4	52.4	95
2" 9/16	635		65.1	65.1	148
3" 1/8	665		79.4	79.4	216
<b>Class 3000</b>					
1" 13/16	645		46	46	107
2" 1/16	645		52.4	52.4	148
2" 9/16	815		65.1	65.1	188
3" 1/8	815		79.4	79.4	255
<b>Class 5000</b>					
1" 13/16	645		46	46	107
2" 1/16	645		52.4	52.4	148
2" 9/16	815		65.1	65.1	317
3" 1/8	815		79.4	79.4	349
<b>Class 10000</b>					
1" 13/16	770		46	46	162
2" 1/16	770		52.4	52.4	457
2" 9/16	1095		65.1	65.1	772
3" 1/16	1140		77.8	77.8	888

Full Bore DN	AA		BB	BB1	Valve Approx. Weight (Kg)
	RTJ				
<b>Class 2000</b>					
2" 1/16 x 1" 13/16	545		46	52.4	79
2" 9/16 x 2" 1/16	635		52.4	65.1	114
3" 1/8 x 2" 9/16	665		65.1	79.4	177
4" 1/16 x 3" 1/8	825		79.4	103.2	257
<b>Class 3000</b>					
2" 1/16 x 1" 13/16	645		46	52.4	118
2" 9/16 x 2" 1/16	815		52.4	65.1	157
3" 1/8 x 2" 9/16	815		65.1	79.4	227
4" 1/16 x 3" 1/8	832		79.4	103.2	303
<b>Class 5000</b>					
2" 1/16 x 1" 13/16	645		46	52.4	118
2" 9/16 x 2" 1/16	815		52.4	65.1	195
3" 1/8 x 2" 9/16	815		65.1	79.4	375
4" 1/16 x 3" 1/8	940		79.4	103.2	408
<b>Class 10000</b>					
2" 1/16 x 1" 13/16	770		46	52.4	190
2" 9/16 x 2" 1/16	1095		52.4	65.1	486
3" 1/16 x 2" 9/16	1140		65.1	79.4	840
4" 1/16 x 3" 1/16	1515		77.8	103.2	965

Dimension AA = Manufacturer Standard

# ASME 150 - 300 - 600 Lbs

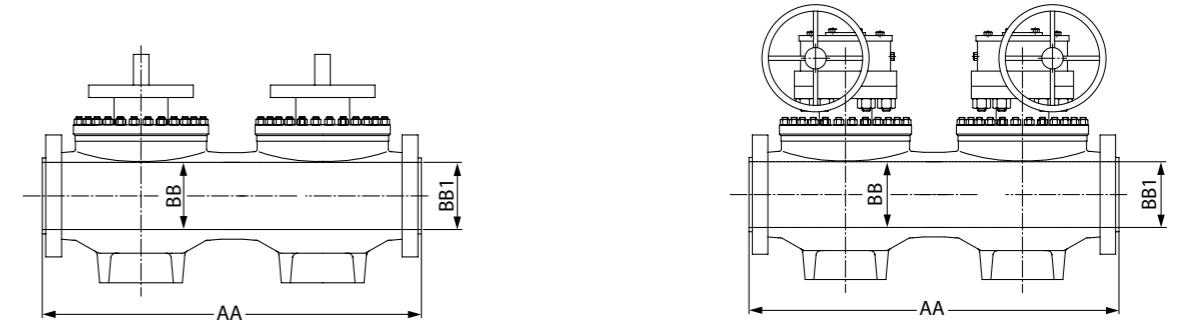

Full Bore DN	AA				Valve Approx. Weight (Kg)	
	RF	RTJ	BW	BB		
<b>Class 150</b>						
6"	1035	1038	1035	150	150	490
8"	1210	1214	1210	201	201	935
10"	1450	1454	1450	252	252	1460
12"	1595	1598	1595	303	303	2055
14"	1715	1718	1715	334	334	2083
16"	1945	1948	1945	385	385	2930
18"	2160	2163	2160	436	436	4026
20"	2365	2371	2365	487	487	5076
24"	2820	2829	2820	589	589	9130
26"	2975	2987	2975	633	633	11180
28"	3180	3193	3180	684	684	12980
30"	3395	3408	3395	735	735	16300
32"	3630	3646	3630	779	779	19065
34"	3910	3926	3910	830	830	21985
36"	4175	4190	4175	874	874	25830
40"	4730	4730	4730	976	976	35500
<b>Class 300</b>						
6"	1035	1038	1035	150	150	490
8"	1210	1214	1210	201	201	935
10"	1450	1454	1450	252	252	1460
12"	1595	1598	1595	303	303	2055
14"	1715	1718	1715	334	334	2083
16"	1945	1948	1945	385	385	2930
18"	2160	2163	2160	436	436	4026
20"	2365	2371	2365	487	487	5076
24"	2820	2829	2820	589	589	9130
26"	2975	2987	2975	633	633	11180
28"	3180	3193	3180	684	684	12980
30"	3395	3408	3395	735	735	16300
32"	3630	3646	3630	779	779	19065
34"	3910	3926	3910	830	830	21985
36"	4175	4190	4175	874	874	25830
40"	4730	4730	4730	976	976	35500
<b>Class 600</b>						
6"	1035	1038	1035	150	150	490
8"	1210	1214	1210	201	201	935
10"	1450	1454	1450	252	252	1460
12"	1595	1598	1595	303	303	2055
14"	1715	1718	1715	334	334	2083
16"	1945	1948	1945	385	385	2930
18"	2160	2163	2160	436	436	4026
20"	2365	2371	2365	487	487	5076
24"	2820	2829	2820	589	589	9130
26"	2975	2987	2975	633	633	11180
28"	3180	3193	3180	684	684	12980
30"	3395	3408	3395	735	735	16300
32"	3630	3646	3630	779	779	19065
34"	3910	3926	3910	830	830	21985
36"	4175	4190	4175	874	874	25830
40"	4730	4730	4730	976	976	35500

Dimension AA = Manufacturer Standard

Reduce Bore DN	AA					Valve Approx. Weight (Kg)
	RF	RTJ	BW	BB	BB1	
<b>Class 150</b>						
8"x6"	1210	1214	1210	150	201	557
10"x8"	1450	1454	1450	201	252	1050
12"x10"	1595	1598	1595	252	303	1555
14"x12"	1715	1718	1715	303	334	2190
16"x14"	1945	1948	1945	334	385	2610
18"x16"	2160	2163	2160	385	436	3230
20"x18"	2365	2371	2365	436	487	4565
24"x20"	2820	2829	2820	487	589	6240
30"x24"	3395	3408	3395	589	735	11350
36"x30"	4175	4190	4175	735	874	20220
<b>Class 300</b>						
8"x6"	1210	1214	1210	150	201	557
10"x8"	1450	1454	1450	201	252	1050
12"x10"	1595	1598	1595	252	303	1555
14"x12"	1715	1718	1715	303	334	2190
16"x14"	1945	1948	1945	334	385	2610
18"x16"	2160	2163	2160	385	436	3230
20"x18"	2365	2371	2365	436	487	4565
24"x20"	2820	2829	2820	487	589	6240
30"x24"	3395	3408	3395	589	735	11350
36"x30"	4175	4190	4175	735	874	20220
<b>Class 600</b>						
8"x6"	1210	1214	1210	150	201	557
10"x8"	1450	1454	1450	201	252	1050
12"x10"	1595	1598	1595	252	303	1555
14"x12"	1715	1718	1715	303	334	2190
16"x14"	1945	1948	1945	334	385	2610
18"x16"	2160	2163	2160	385	436	3230
20"x18"	2365	2371	2365	436	487	4565
24"x20"	2820	2829	2820	487	589	6240
30"x24"	3395	3408	3395	589	735	11350
36"x30"	4175	4190	4175	735	874	20220

# ASME 900 - 1500 - 2500 Lbs

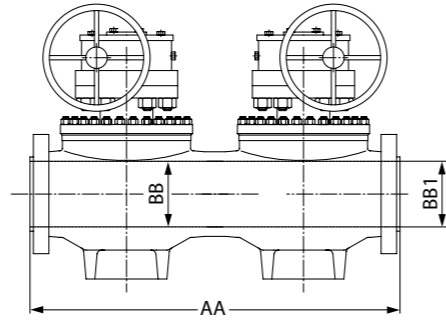
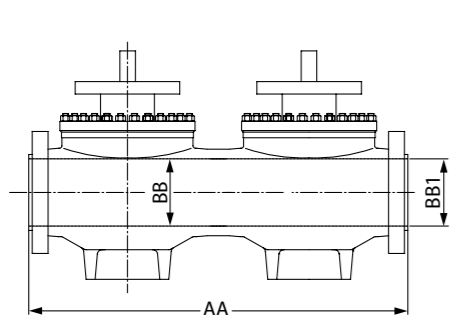

Full Bore DN	AA			BB	BB1	Valve Approx. Weight (Kg)
	RF	RTJ	BW			
<b>Class 900</b>						
6"	1140	1143	1140	150	150	705
8"	1290	1293	1290	201	201	1152
10"	1510	1513	1510	252	252	1974
12"	1770	1773	1770	303	303	2990
14"	1885	1894	1885	322	322	2836
16"	2110	2120	2110	373	373	4141
18"	2330	2343	2330	423	423	5492
20"	2530	2542	2530	471	471	8102
24"	3025	3044	3025	570	570	13140
<b>Class 1500</b>						
6"	1260	1266	1260	144	144	932
8"	1480	1489	1480	192	192	1588
10"	1780	1789	1780	239	239	2895
12"	1990	2006	1990	287	287	4362
14"	2210	2229	2210	315	315	5530
16"	2450	2472	2450	360	360	7910
18"	2725	2747	2725	406	406	12020
20"	3010	3032	3010	454	454	17510
24"	3650	3678	3650	546	546	27500
<b>Class 2500</b>						
6"	2805	2818	2805	131	131	1594
8"	1750	1766	1750	179	179	2755
10"	2130	2152	2130	223	223	4262
12"	2350	2373	2350	265	265	6432

Reduce Bore DN	AA					Valve Approx. Weight (Kg)
	RF	RTJ	BW	BB	BB1	
<b>Class 900</b>						
8"x6"	1290	1293	1290	150	201	858
10"x8"	1510	1513	1510	201	252	1344
12"x10"	1770	1773	1770	252	303	2204
14"x12"	1885	1894	1885	303	322	3154
16"x14"	2110	2120	2110	322	373	3297
18"x16"	2330	2343	2330	373	423	4678
20"x18"	2530	2542	2530	423	471	6260
24"x20"	3025	3044	3025	471	570	10425
<b>Class 1500</b>						
8"x6"	1480	1489	1480	144	192	1104
10"x8"	1780	1789	1780	192	239	1980
12"x10"	1990	2006	1990	239	287	3392
14"x12"	2210	2229	2210	287	315	4870
16"x14"	2450	2472	2450	315	360	6297
18"x16"	2725	2747	2725	360	406	9564
20"x18"	3010	3032	3010	406	454	14478
24"x20"	3650	3678	3650	454	546	21024
<b>Class 2500</b>						
8"x6"	1750	1766	1750	131	179	2208
10"x8"	2130	2152	2130	179	223	3360
12"x10"	2350	2373	2350	223	265	5088

Dimension AA = Manufacturer Standard

# API 2000 - 3000 - 5000 - 10000 psi

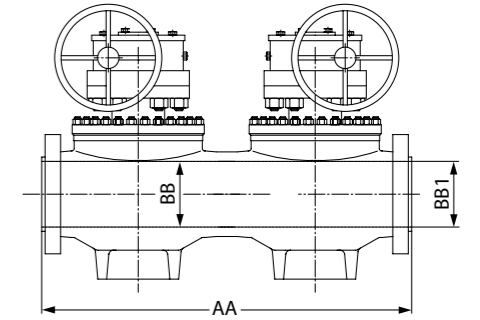
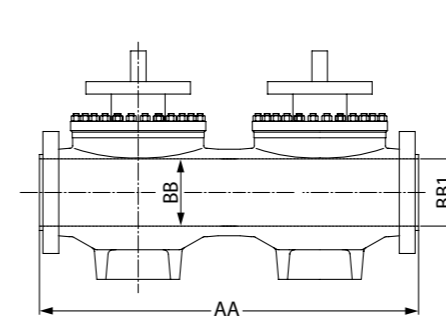

Full Bore DN	AA	BB	BB1	Valve Approx. Weight (Kg)
	RTJ			
<b>Class 2000</b>				
4" 1/16	825	103.2	103.2	269
5" 1/8	1035	130.2	130.2	423
7" 1/16	1335	179.4	179.4	538
<b>Class 3000</b>				
4" 1/16	835	103.2	103.2	375
5" 1/8	1145	130.2	130.2	864
7" 1/16	1145	179.4	179.4	1480
<b>Class 5000</b>				
4" 1/16	940	103.2	103.2	394
5" 1/8	1310	130.2	130.2	1075
7" 1/16	1370	179.4	179.4	1632
<b>Class 10000</b>				
4" 1/16	1210	103.2	103.2	826
5" 1/8	1470	130.2	130.2	1620
7" 1/16	1790	179.4	179.4	2838

Full Bore DN	AA	BB	BB1	Valve Approx. Weight (Kg)
	RTJ			
<b>Class 2000</b>				
5" 1/8 x 4" 1/16	1035	103.2	130.2	355
7" 1/16 x 5" 1/8	1335	130.2	179.4	461
-	-	-	-	-
<b>Class 3000</b>				
5" 1/8 x 4" 1/16	1145	103.2	130.2	502
7" 1/16 x 5" 1/8	1145	130.2	179.4	922
-	-	-	-	-
<b>Class 5000</b>				
5" 1/8 x 4" 1/16	1310	103.2	130.2	576
7" 1/16 x 5" 1/8	1370	130.2	179.4	1190
-	-	-	-	-
<b>Class 10000</b>				
5" 1/8 x 4" 1/16	1470	103.2	130.2	979
7" 1/16 x 5" 1/8	1790	130.2	179.4	2406
-	-	-	-	-

Dimension AA = Manufacturer Standard

# Floating Split Body

## Main Features

- Split Body - All forged construction.
- Soft / Metal Seated.
- Self Relieving.
- Anti Blow-Out stem.
- Fire safe API 6FA - API 607 ISO 10497.
- Antistatic device.
- Materials in accordance to NACE MR 01.75.

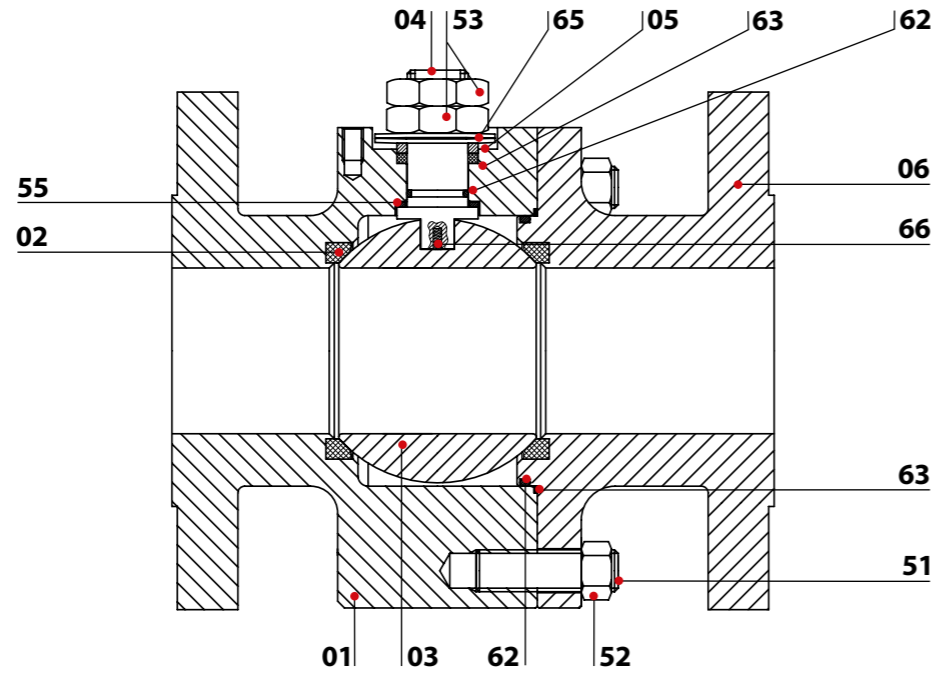

## Valve Parts

Pos.	Description
01	Body
02	Seat
03	Ball
04	Stem
05	Gland
06	Flange
51	Stud
52	Nut
53	Stem Nut
55	Thrust Washer
62	Seal
63	Gasket
65	Spring Washer
66	Antistatic Spring

# ASME 150 - 300 - 600 - 900 - 1500 - 2500 Lbs

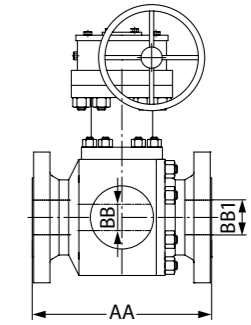
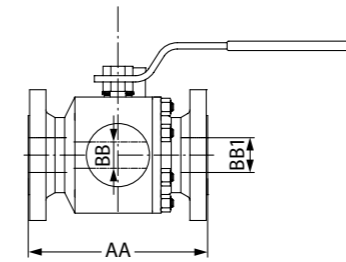

Full Bore DN	AA					Valve Approx. Weight (Kg)
	RF	RTJ	BW	BB	BB1	
<b>Class 150</b>						
1/2"	108	108	140	13	13	3
3/4"	117.5	117.5	152.5	19	19	4
1"	127	127	165	25	25	5
1 1/2"	165	178	190	38	38	12
2"	178	190	216	49	49	15
3"	203	216	283	74	74	21
4"	229	241	305	100	100	45

Full Bore DN	AA					Valve Approx. Weight (Kg)
	RF	RTJ	BW	BB	BB1	
<b>Class 300</b>						
1/2"	140	140	140	13	13	3.4
3/4"	152.5	152.5	152.5	19	19	4.5
1"	165	165	165	25	25	5.5
1 1/2"	190	203	190	38	38	18
2"	216	232	216	49	49	22
3"	283	298	283	74	74	35
4"	305	321	305	100	100	50

Full Bore DN	AA					Valve Approx. Weight (Kg)
	RF	RTJ	BW	BB	BB1	
<b>Class 600</b>						
1/2"	165	165	165	13	13	5
3/4"	190.5	190.5	190.5	19	19	7
1"	216	216	216	25	25	10
1 1/2"	241	241	241	38	38	18
2"	292	295	292	49	49	24
3"	356	359	356	74	74	60

Full Bore DN	AA					Valve Approx. Weight (Kg)
	RF	RTJ	BW	BB	BB1	
<b>Class 900</b>						
1/2"	216	216	216	13	13	8
3/4"	229	229	229	19	19	12
1"	254	254	254	25	25	18
1 1/2"	305	305	305	38	38	35
2"	368	371	368	49	49	45

Full Bore DN	AA					Valve Approx. Weight (Kg)
	RF	RTJ	BW	BB	BB1	
<b>Class 1500</b>						
1/2"	216	216	216	13	13	8
3/4"	229	229	229	19	19	12
1"	254	254	254	25	25	18
1 1/2"	305	305	305	38	38	35
2"	368	371	368	49	49	45

Full Bore DN	AA					Valve Approx. Weight (Kg)
	RF	RTJ	BW	BB	BB1	
<b>Class 2500</b>						
1/2"	264	264	264	13	13	10
3/4"	273	273	273	19	19	14
1"	308	308	308	25	25	22

Reduce Bore DN	AA					Valve Approx. Weight (Kg)
	RF	RTJ	BW	BB	BB1	
<b>Class 150</b>						
3/4" x 1/2"	117.5	117.5	152.5	13	19	4
1" x 3/4"	127	127	165	19	25	4.5
1 1/2" x 1"	165	178	190	25	38	11
2" x 1 1/2"	178	190	216	38	49	13
3" x 2"	203	216	283	49	74	19
4" x 3"	229	241	305	74	100	35
6" x 4"	394	406	457	100	152	65

Reduce Bore DN	AA					Valve Approx. Weight (Kg)
	RF	RTJ	BW	BB	BB1	
<b>Class 300</b>						
3/4" x 1/2"	152.5	152.5	152.5	13	19	4.5
1" x 3/4"	165	165	165	19	25	5.5
1 1/2" x 1"	190	203	190	25	38	15
2" x 1 1/2"	216	232	216	38	49	20
3" x 2"	283	298	283	49	74	28
4" x 3"	305	321	305	74	100	42
6" x 4"	403	419	457	100	152	73

Reduce Bore DN	AA					Valve Approx. Weight (Kg)
	RF	RTJ	BW	BB	BB1	
<b>Class 600</b>						
3/4" x 1/2"	190.5	190.5	190.5	13	19	6
1" x 3/4"	216	216	216	19	25	8
1 1/2" x 1"	241	241	241	25	38	12
2" x 1 1/2"	292	295	292	38	49	20
3" x 2"	356	359	356	49	74	28
4" x 3"	432	435	432	74	100	75

Reduce Bore DN	AA					Valve Approx. Weight (Kg)
	RF	RTJ	BW	BB	BB1	
<b>Class 900</b>						
3/4" x 1/2"	229	229	229	13	19	10
1" x 3/4"	254	254	254	19	25	14
1 1/2" x 1"	305	305	305	25	38	26
2" x 1 1/2"	368	371	368	38	49	42
3" x 2"	381	384	381	49	74	55

Reduce Bore DN	AA					Valve Approx. Weight (Kg)
	RF	RTJ	BW	BB	BB1	
<b>Class 1500</b>						
3/4" x 1/2"	229	229	229	13	19	10
1" x 3/4"	254	254	254	19	25	14
1 1/2" x 1"	305	305	305	25	38	26
2" x 1 1/2"	368	371	368	38	49	42
3" x 2"	470	473	470	49	74	55

Reduce Bore DN	AA					Valve Approx. Weight (Kg)
	RF	RTJ	BW	BB	BB1	
<b>Class 2500</b>						
3/4" x 1/2"	273	273	273	13	19	12
1" x 3/4"	308	308	308	19	25	18
1 1/2" x 1"	422	422	422	25	38	30



# Floating DBB

## Main Features

- Bolted Body Forged Construction.
- Soft / Metal Seated.
- Self Relieving.
- Anti Blow-Out stem.
- Fire safe API 6FA - API 607 ISO 10497.
- Antistatic device.
- Materials in accordance to NACE MR 01.75.

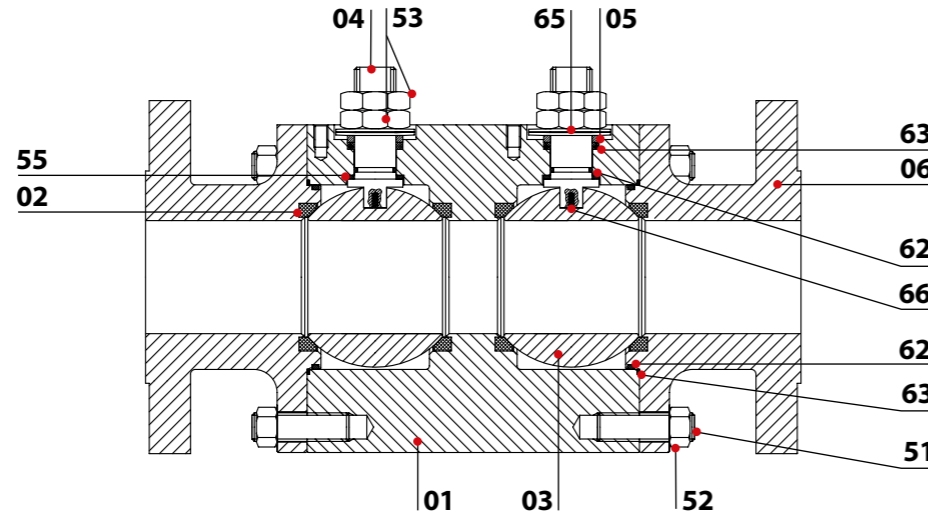

## Valve Parts

Pos.	Description
01	Body
02	Seat
03	Ball
04	Stem
05	Gland
06	Flange
51	Stud
52	Nut
53	Stem Nut
55	Thrust Washer
62	Seal
63	Gasket
65	Spring Washer
66	Antistatic Spring

## Bleed Types



**Bleeder Bonnet**



**Bleeder Needle Bonnet**



**Bleeder Needle Flanged**



**O. S. & Y Type Globe Valve**

# ASME 150 - 300 - 600 - 900 - 1500 - 2500 Lbs

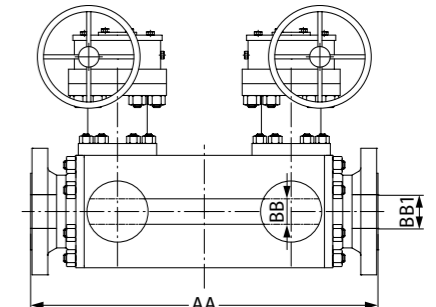
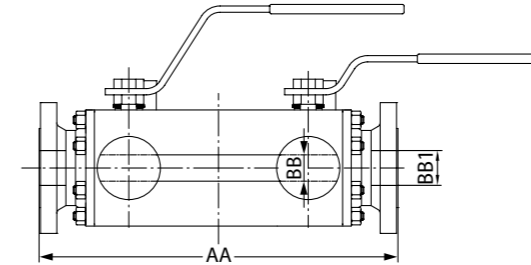

Full Bore DN	AA					Valve Approx. Weight (Kg)
	RF	RTJ	BW	BB	BB1	
<b>Class 150</b>						
1/2"	185	185	210	13	13	4.8
3/4"	190	190	215	19	19	6.4
1"	205	205	225	25	25	7.5
1 1/2"	265	265	285	38	38	18
2"	300	313	305	49	49	23
3"	380	393	425	74	74	32
4"	435	448	480	100	100	68
<b>Class 300</b>						
1/2"	210	210	210	13	13	5.4
3/4"	215	215	215	19	19	7.5
1"	225	225	225	25	25	9
1 1/2"	285	285	285	38	38	29
2"	305	321	305	49	49	36
3"	425	441	425	74	74	56
4"	480	496	480	100	100	75
<b>Class 600</b>						
1/2"	240	240	240	13	13	8
3/4"	255	255	255	19	19	11.5
1"	260	260	260	25	25	16
1 1/2"	315	315	315	38	38	32
2"	385	388	385	49	49	39
3"	495	498	495	74	74	96
<b>Class 900</b>						
1/2"	260	260	260	13	13	13
3/4"	270	270	270	19	19	20
1"	300	300	300	25	25	29
1 1/2"	385	385	385	38	38	56
2"	450	453	450	49	49	72
<b>Class 1500</b>						
1/2"	260	260	260	13	13	13
3/4"	270	270	270	19	19	20
1"	300	300	300	25	25	29
1 1/2"	385	385	385	38	38	56
2"	450	453	450	49	49	72
<b>Class 2500</b>						
1/2"	320	320	320	13	13	16
3/4"	335	335	335	19	19	23
1"	370	370	370	25	25	35

Reduce Bore DN	AA					Valve Approx. Weight (Kg)
	RF	RTJ	BW	BB	BB1	
<b>Class 150</b>						
3/4" x 1/2"	190	190	215	13	19	5.8
1" x 3/4"	205	205	225	19	25	6.9
1 1/2" x 1"	265	265	285	25	38	13.5
2" x 1 1/2"	300	313	305	38	49	19
3" x 2"	380	393	425	49	74	27
4" x 3"	435	448	480	74	100	46
6" x 4"	580	592	590	100	152	88
<b>Class 300</b>						
3/4" x 1/2"	215	215	215	13	19	6.5
1" x 3/4"	225	225	225	19	25	8.5
1 1/2" x 1"	285	285	285	25	38	18.5
2" x 1 1/2"	305	321	305	38	49	31
3" x 2"	425	441	425	49	74	42
4" x 3"	480	496	480	74	100	73
6" x 4"	590	606	590	100	152	98
<b>Class 600</b>						
3/4" x 1/2"	255	255	255	13	19	9
1" x 3/4"	260	260	260	19	25	12.5
1 1/2" x 1"	315	315	315	25	38	18
2" x 1 1/2"	385	388	385	38	49	36
3" x 2"	495	498	495	49	74	45
4" x 3"	570	573	570	74	100	111
<b>Class 900</b>						
3/4" x 1/2"	270	270	270	13	19	15
1" x 3/4"	300	300	300	19	25	22
1 1/2" x 1"	385	385	385	25	38	37
2" x 1 1/2"	450	453	450	38	49	63
3" x 2"	500	503	500	49	74	82
<b>Class 1500</b>						
3/4" x 1/2"	270	270	270	13	19	15
1" x 3/4"	300	300	300	19	25	22
1 1/2" x 1"	385	385	385	25	38	37
2" x 1 1/2"	450	453	450	38	49	63
3" x 2"	505	508	505	49	74	82
<b>Class 2500</b>						
3/4" x 1/2"	335	335	335	13	19	19
1" x 3/4"	370	370	370	19	25	29
1 1/2" x 1"	410	410	410	25	38	48

Dimension AA = Manufacturer Standard

# DK-Lok Worldwide

## Reference List

**ADCO**  
**ADGAS**  
**AVL**  
**BASF**  
The Chemical Company  
**BOSCH**  
**CAMERON**  
**ConocoPhillips**  
**DAELIM**  
**DAEWOO E&C**  
**DOOSAN**  
**DOW**  
**DSME**  
**EagleBurgmann**  
**EMERSON**  
Process Management  
**GS Caltex Corporation**  
**GS E&C Corporation**  
**Hanwha**  
**HYUNDAI ENGINEERING CO., LTD.**  
**HYUNDAI HEAVY INDUSTRIES CO., LTD.**  
**eni**  
**ExxonMobil**

**KHN** **LUKOIL**  
OIL COMPANY **TAKREER**  
شركة أبوظبي لتكرير النفط

PetroChina



## **DK-LOK** Corporation

7, Golden Root-Ro 129 Beon Gil, Juchon-Myeon,  
Gimhae City, South Korea 50969

Ph. +82 55 338 0114

Fax +82 55 901 0146

[valvesinfo@dklok.com](mailto:valvesinfo@dklok.com)

Ph. +82 70 4707 9690

[www.dklok.com](http://www.dklok.com)



• Seoul

South Korea

Gimhae City •

Busan •